

COOL BREEZE
air conditioning



2022 COOLBREEZE

SPARE PARTS

catalogue

EFFECTIVE OCTOBER 1ST 2021

COOLBREEZE

SPARE PARTS CATALOGUE

RESIDENTIAL, COMMERCIAL & MOBILE DOWN, SIDE & TOP DISCHARGE MODELS

RANGE	CONTROLLER	MODEL	YEAR	MOTOR	PAGES
MODEL & COMPONENT IDENTIFICATION CHART					12 - 13
EXPLODED DIAGRAMS					
HERITAGE	QA / QM / L / R	D095 - D255	2000 on	600/750/1000W	15 - 17
CASCADE	QA / QM / L / R	C125 - C240	2000 on	600/750/1000W	19 - 21
COMMERCIAL RANGE:					23
TWIN FAN	QA / QM	D500	2000 on	1000W x 2	24 - 25
TOP Discharge	QA / QM	T255	2000 on	1000W	26 - 27
SIDE Discharge	QA / QM	S240	2000 on	1000W	28 - 29
SIDE Discharge	QA / QM	S100 / S105	2000 on	600W	30 - 31
MOBILE UNITS:					33
MOBILE	Rotary	M200 / M240	2000-2019	1000W	34 - 35
MOBILE	QM	M240WC	2020 on	1000W	36 - 37
SPARE PARTS LISTING					
MANIFOLDS & SOLENOIDS					40
FLOATS & PUMPS					41
DRAINS & VALVES					42
MOTORS & CAPACITORS					43
FANS & MOTOR PACKS					44
CABLES					45
CIRCUIT BOARDS					46
CONTROLLERS & KEYPADS					47
CORNER POSTS					48
SUMPS & LIDS					49
LOUVRES - SPRAY PAINT					50
ZONE SYSTEMS & MOTORS					51
FILTER PADS					
COOLBREEZE MODELS					53 - 56
OTHER BRANDS					59

PART IDENTIFICATION

WALL CONTROLLERS



CA MANUAL
NLA - USE SP3220



CO AUTO
NLA - USE SP3221



CR AUTO
NLA - USE SP3221



CY MANUAL
NLA - USE SP3220
OVERLAY - SP3516



L Series
SP3506
OVERLAY - SP3517



MX / MX PLUS
SP3222



R Series (a)
NLA - USE SP3504



R Series (b)
SP3504



QM 2005-16
NLA - USE SP3220
OVERLAY - SP3515



QM 2017 on
SP3220



QA 2005-16
NLA - USE SP3221
OVERLAY - SP3518



QA 2017 on
SP3221

SHROUDED & NON-SHROUDED MOTOR RINGS



Non-Shrouded Motor Ring - fan is above the ring

MOTOR PACKS INCLUDE FAN AND MOTOR ASSEMBLED TO MOTOR RING
Includes Grommets & Collets

NON-SHROUDED MOTOR RING - SP6022

NON-SHROUDED MOTOR PACK:
600W - SP6081
750W - SP6077
1000W - SP6075



Shrouded Motor Ring - fan is inside the ring

SHROUDED MOTOR RING - SP6025

SHROUDED MOTOR PACK:
600W - SP6078
750W - SP6076
1000W - SP6074

FAN ID



GREY BLADES / GREEN HUB
SUITS 600W MOTOR
518mm Dia. - SP6028
524mm Dia. - SP6027
528mm Dia. - SP6057

USE COLLET SET - SP6043



GREY BLADES / GREY HUB
SUITS 750W MOTOR
518mm Dia. - SP6039
524mm Dia. - SP6030
528mm Dia. - SP6058

USE COLLET SET - SP6043



BLACK POWERFLOW FAN
SUITS 1000W MOTOR
518mm Dia. - SP6033
524mm Dia. - SP6072

USE COLLET SET - SP6073

NOTE: ALWAYS REPLACE COLLETS WHEN REPLACING FAN

MOTOR ID

EC STD MOTORS



370W
NLA - use SP6012



600W
SP6012



750w
SP6014



1000w
SP6015

MAXIMA INVERTER MOTORS



MAXIMA series 1
replaced by SP6087
2016 - 2017



MAXIMA series 2
SP6087
2018 on

PART IDENTIFICATION

CIRCUIT BOARDS

CFRU SP3510



1996 - 2005 with
L or R Controllers

MRU SP3000

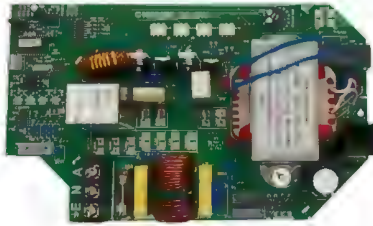

2000 on with QA or
QM Controllers

ECRU SP3011 MAXIMA

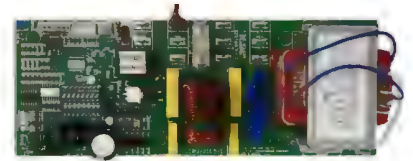

2016 on MAXIMA only with
QA or QM Controllers

WATER DRAIN VALVES



HYDRAULIC DRAIN
1990 - 1996
SP2064
(requires SP2640 Solenoid)



ELECTRIC DRAIN
1996 - 2001
NO LONGER AVAILABLE
replaced with SP2082



COUNTER-WEIGHT DRAIN
2000 on
SP2040



SERVICE MAINTENANCE KIT
includes Hoses, Clamps & Blue
O-ring - SP2117

**BLUE O-RING - SP2066C BLACK Sq
Section O-RING - SP2066 BLACK
Round O-RING - SP2068**

FLOAT ASSEMBLY



FLUIDMASTER 703
1994-2000
NLA - USE SP2027



FLUIDMASTER 747
SP2027



MS WATER LEVEL SENSOR
SP2212



MWL WATER LEVEL SENSOR*
SP2210



MAGNETIC FLOAT ASSY
SP2200

*Compatible with CFRU Board only

MODEL SIZE ID CHART

Count the number of louvres on one side

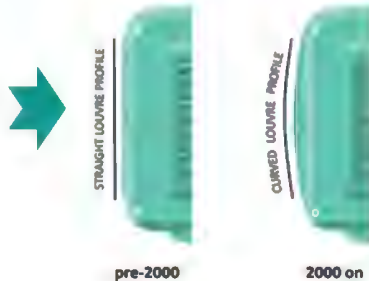

Cascade (Sloping Base) Style Units

Count the number of louvres on the Front (tall) side



Rows of Louvres	Model	Year	Motor	Pad Width x	Height x	Thickness
7 rows	D095	2000 on	600w	830 x	370 x	75
9 rows	105	pre 2000	600w	735 x	400 x	75
10 rows	D125	2000 on	600w	830 x	460 x	75
10 rows	D160	2000 on	750w	830 x	460 x	100
12 rows	130	pre 2000	600w	735 x	495 x	75
12 rows	160	pre 2000	750w	840 x	495 x	75
12 rows	D195	2000 on	1000w	830 x	535 x	100
15 rows	D230	2000 on	1000w	830 x	650 x	100
17 rows	185	pre 2000	1000w	840 x	630 x	75
19 rows	D255	2000 on	1000w	830 x	770 x	100
20 rows	210	pre 2000	1000w	840 x	730 x	75
Cascade (Sloping Base) Style Units						
15 rows	C125	2000 on	600w	830 x	640 x	75
15 rows	C160	2000 on	750w	830 x	640 x	100
19 rows	C205	2000 on	1000w	830 x	760 x	100
22 rows	C240	2000 on	1000w	830 x	870 x	100

HERITAGE 2000 on



All Models Available in All Colours



R series



2002 - 2003
SP3504

L series AUTO



2003 - 2005
SP3506



CFRU SP3510

CA MANUAL



2000 - 2002

CY MANUAL



2000 - 2002

QM MANUAL



2005 - 2016



2016 on

REPLACED BY SP3220

SP3220

CR AUTO



2000 - 2002

QA AUTO

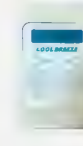

2005 - 2016



2016 on

REPLACED BY SP3221

SP3221

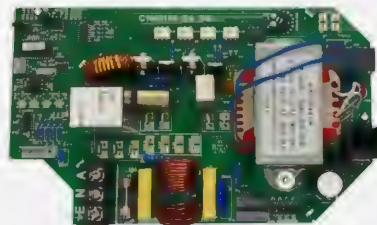

MRU SP3000

ECRU SP3011 MAXIMA
2016 on MAXIMA
inverter only

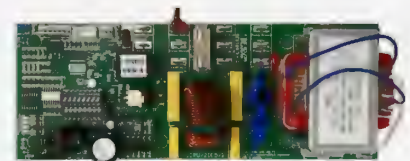

CIRCUIT BOARDS

CFRU SP3510



1996 - 2005 with
L or R Controllers

MRU SP3000

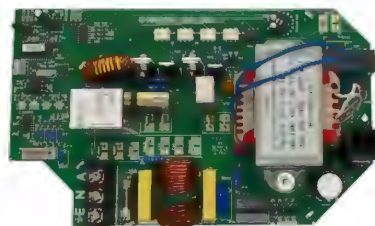

2000 on with QA or
QM Controllers

ECRU SP3011 MAXIMA

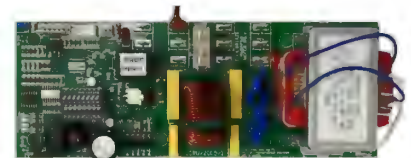

2016 on MAXIMA only with
QA or QM Controllers











MODEL SIZE ID CHART

Count the number of louvres on one side



Rows of Louvres	Model	Year	Motor	Pad Width x	Height x	Thickness
7 rows	D095	2000 on	600w	830 x	370 x	75
10 rows	D125	2000 on	600w	830 x	460 x	75
10 rows	D160	2000 on	750w	830 x	460 x	100
12 rows	D195	2000 on	1000w	830 x	535 x	100
15 rows	D230	2000 on	1000w	830 x	650 x	100
19 rows	D255	2000 on	1000w	830 x	770 x	100

2000 on: HERITAGE D095 - D255

R series		L series AUTO		CA MANUAL	CY MANUAL	QM MANUAL	CR AUTO	QA AUTO		
										
NLA	2002 - 2003	2003 - 2005		2000 - 2002	2000 - 2002	2005 - 2016	2016 on	2000 - 2002	2005 - 2016	2016 on
use SP3504	SP3504	SP3506		REPLACED BY SP3220			SP3220	REPLACED BY SP3221		SP3221
uses CFRU BOARD - SP3510				uses MRU BOARD - SP3000 (except Maxima Inverter - ECRU BOARD - SP3011)						

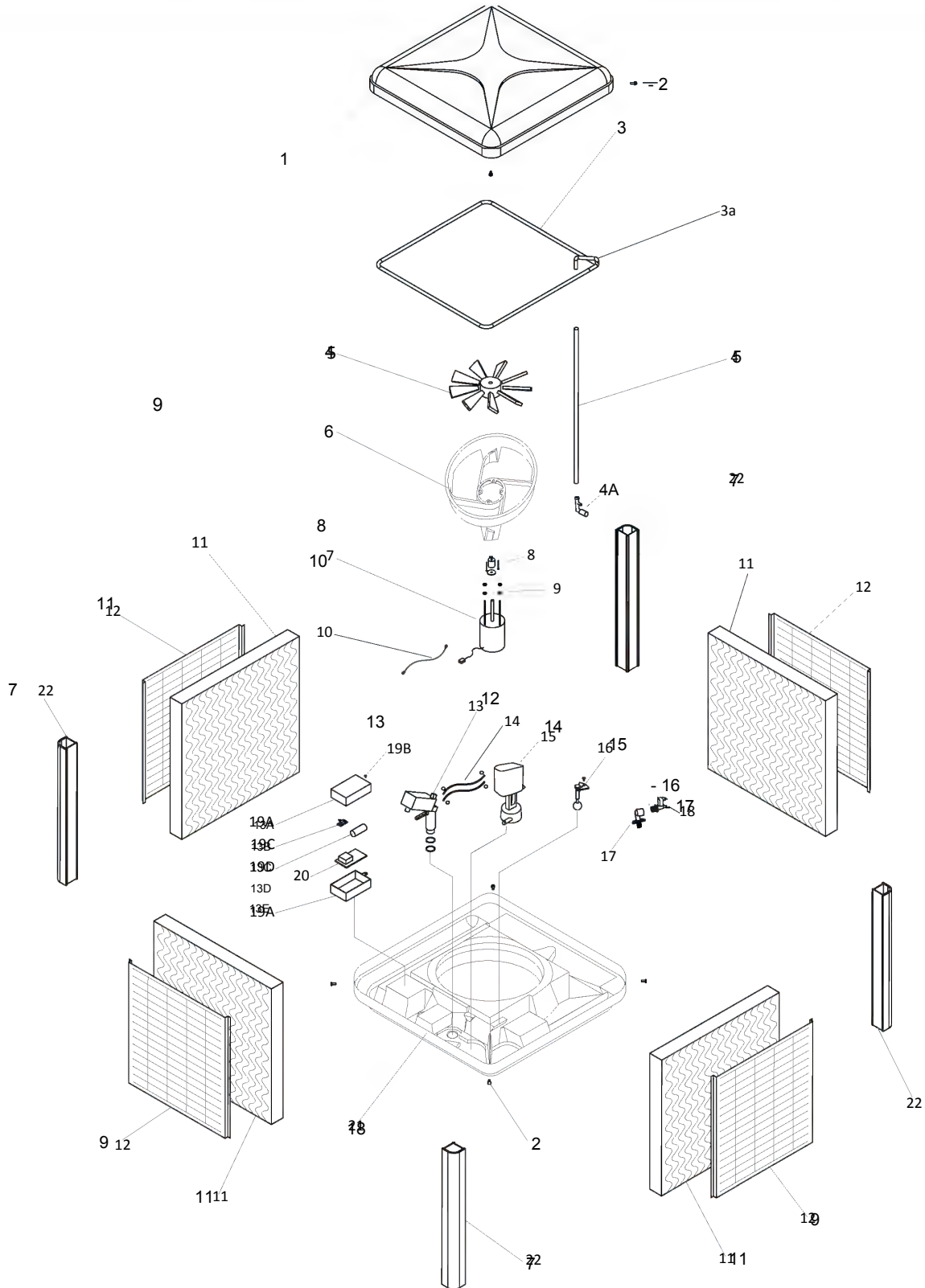

1 LID			Part No.				
D series		<i>*Specify Colour</i>	SP1010*				
2 BOLT SET							
D series		<i>*Specify Colour</i>	SP4049*				
3 MANIFOLD							
D series	Manifold Assembly		SP2007				
A D series	Corner Repair Kit		SP2528				
4 WATER RISER PIPE							
D095	370mm long Riser Pipe		SP2100				
D125/160	460mm long Riser Pipe		SP2102				
D195	535mm long Riser Pipe		SP2104				
D230	650mm long Riser Pipe		SP2106				
D255	770mm long Riser Pipe		SP2108				
A D series	Pump T piece		SP2043				
5 FAN	Motor	Fan Diameter					
D095/125	600W	518mm diameter Fan	SP6028				
D095/125	600W	524mm diameter Fan	SP6027				
D095/125	600W	528mm diameter Fan	SP6057				
D160	750W	518mm diameter Fan	SP6039				
D160	750W	524mm diameter Fan	SP6030				
D160	750W	528mm diameter Fan	SP6058				
D195/230/255	1000W	518mm diameter Fan	SP6033				
D195/230/255	1000W	524mm diameter Fan	SP6072				
6 MOTOR RING		<i>refer page 12</i>					
2000-02	Non-Shrouded Type		SP6022				
2003 on	Shrouded Type		SP6025				
7 MOTOR							
D095/125	600W std Motor		SP6012				
D160	750W Motor		SP6014				
D195/230/255	1000W Motor		SP6015				
D series	Maxima Inverter Motor		SP6087				
FAN & MOTOR PACK	inc Motor, Fan, Ring, Grommets & Collet						
2000-02	600W std Motor (non-shrouded ring)		SP6081				
2003 on	600W std Motor (shrouded ring)		SP6078				
D095/125	Maxima Inverter Motor		SP6085				
2000-02	750W std Motor (non-shrouded ring)		SP6077				
2003 on	750W std Motor (shrouded ring)		SP6076				
D160	Maxima Inverter Motor		SP6084				
2000-02	1000W std Motor (non-shrouded ring)		SP6075				
2003 on	1000W std Motor (shrouded ring)		SP6074				
2016 on	Maxima Inverter Motor		SP6086				
8 FAN COLLET SET							
D095/125/160	600W & 750W motor		SP6043				
D195/230/255	1000W motor		SP6073				
9 MOUNTING GROMMET SET							
D series	inc. 8 grommets, washers & nuts		SP6024				
10 MOTOR ANCHOR CABLE							
D series			SP6048				
11 ECOPADS FILTER PADS - set of 4 pads				Part No.			
D095	830 x 370 x 75			SP4300/4			
D125	830 x 460 x 75			SP4302/4			
D160	830 x 460 x 100			SP4304/4			
D195	830 x 535 x 100			SP4306/4			
D230	830 x 650 x 100			SP4308/4			
D255	830 x 770 x 100			SP4310/4			
12 LOUVRES - sold individually		<i>*Specify Colour</i>					
D095				SP066*			
D125/160				SP068*			
D195				SP070*			
D230				SP072*			
D255				SP074*			
13 DRAIN VALVE							
A D series	Counter-weight Drain Valve			SP2040			
B D series	Blue O ring			SP2066C			
14 HOSE SET - PUMP to DRAIN							
D series	Hose Kit inc clamps			SP2042			
15 SUPER PUMP							
D series	Super Pump			SP2380			
16 WATER SENSOR							
A D series	MS Water Sensor*			SP2212			
B D series	MFA Magnetic Float			SP2200			
						<i>*if unit fitted with CFRU use SP2210 - see page 13</i>	
17 THROUGH SUMP ELBOW							
D series				SP2039			
18 SOLENOID							
D series	inc. solenoid, hose, clamps & cables			SP2134			

CONTINUED ON NEXT PAGE >

19 ELECTRICAL BOX

A	D series	inc. box, lid, bracket & switch	SP3045
B	D series	Plastic Bolts - pack of 4	SP3053
C	D series	Main Switch - 240v	SP3198
D	D095/125	Capacitor 25uF	SP3039
D	D160-D255	Capacitor 30uF	SP3040
E	D series	Capacitor Cover	SP3042

20 MRU CIRCUIT BOARD *refer page 13*

	L or R Keypad	CFRU Board	SP3058
	QM or QA Keypad	MRU Board	SP3000
A	All except Maxima	Fuse - 15amp - Slow Blow	SP3510
	Maxima Inverter	ECRU Board	SP3011

21 SUMP **Specify Colour*

	D series	SP1009*
--	----------	----------------

22 CORNER POSTS **Specify Colour*

	D095	370mm high - 75mm pads	SP4066*
	D125	460mm high - 75mm pads	SP4068*
	D160	460mm high - 100mm pads	SP4070*
	D195	535mm high - 100mm pads	SP4072*
	D230	650mm high - 100mm pads	SP4074*
	D255	770mm high - 100mm pads	SP4076*

SERVICE KIT (NOT SHOWN)

	D series	inc hoses, clamps & blue O ring	SP2117
--	----------	---------------------------------	---------------

CABLES (NOT SHOWN)

	D series	240v Power Cable	SP3031
	D series	Board to Motor - 6pin male - 950mm	SP6020
	D series	Board to Controller Cable - 7pin - 15m	SP5200

WATER INLET TAP

	D series	SP2076
--	----------	---------------

WATER RESTRICTOR TAP (RISER PIPE)

	D series	SP2010
--	----------	---------------

CASCADE 2000 on



C125 C160 C205 C240

All Models Available in All Colours



R series



2002 - 2003
SP3504

L series AUTO



2003 - 2005
SP3506



CFRU SP3510

CA MANUAL



2000 - 2002

CY MANUAL



2000 - 2002

QM MANUAL



2005 - 2016



2016 on

REPLACED BY SP3220

SP3220

CR AUTO



2000 - 2002

QA AUTO



2005 - 2016

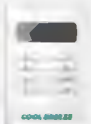

2016 on

REPLACED BY SP3221

SP3221

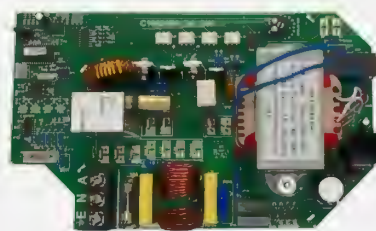

MRU SP3000

ECRU SP3011 MAXIMA
2016 on MAXIMA
inverter only

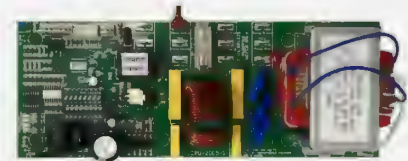

MOTOR ID

EC STD MOTORS



600W
SP6012



750w
SP6014



1000w
SP6015

2000 on

MAXIMA INVERTER MOTORS



MAXIMA series 1
replaced by SP6087

2016 - 2017



MAXIMA series 2
SP6087

2018 on







MODEL SIZE ID CHART

Count the number of louvres on the Front side.

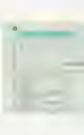

Rows of Louvres	Model	Year	Motor	Pad Width x	Height	x	Thickness
15 rows	C125	2000 on	600w	830	x	640	x 75
15 rows	C160	2000 on	750w	830	x	640	x 100
19 rows	C205	2000 on	1000w	830	x	760	x 100
22 rows	C240	2000 on	1000w	830	x	870	x 100

2000 on: CASCADE C125 - C240

R series	L series AUTO	CA MANUAL	CY MANUAL	QM MANUAL	CR AUTO	QA AUTO		
								
cccccc cccc2002 - cccc	cccccccc 2005	2000 - 2002	2000 - 2002	2005 - 2016	2016 on	2000 - 2002	2005 - 2016	2016 on
use SP3504	SP3504	REPLACED BY SP3220			SP3220	REPLACED BY SP3221		SP3221
uses CFRU BOARD - SP3510			uses MRU BOARD - SP3000 (except Maxima Inverter - ECRU BOARD - SP3011)					

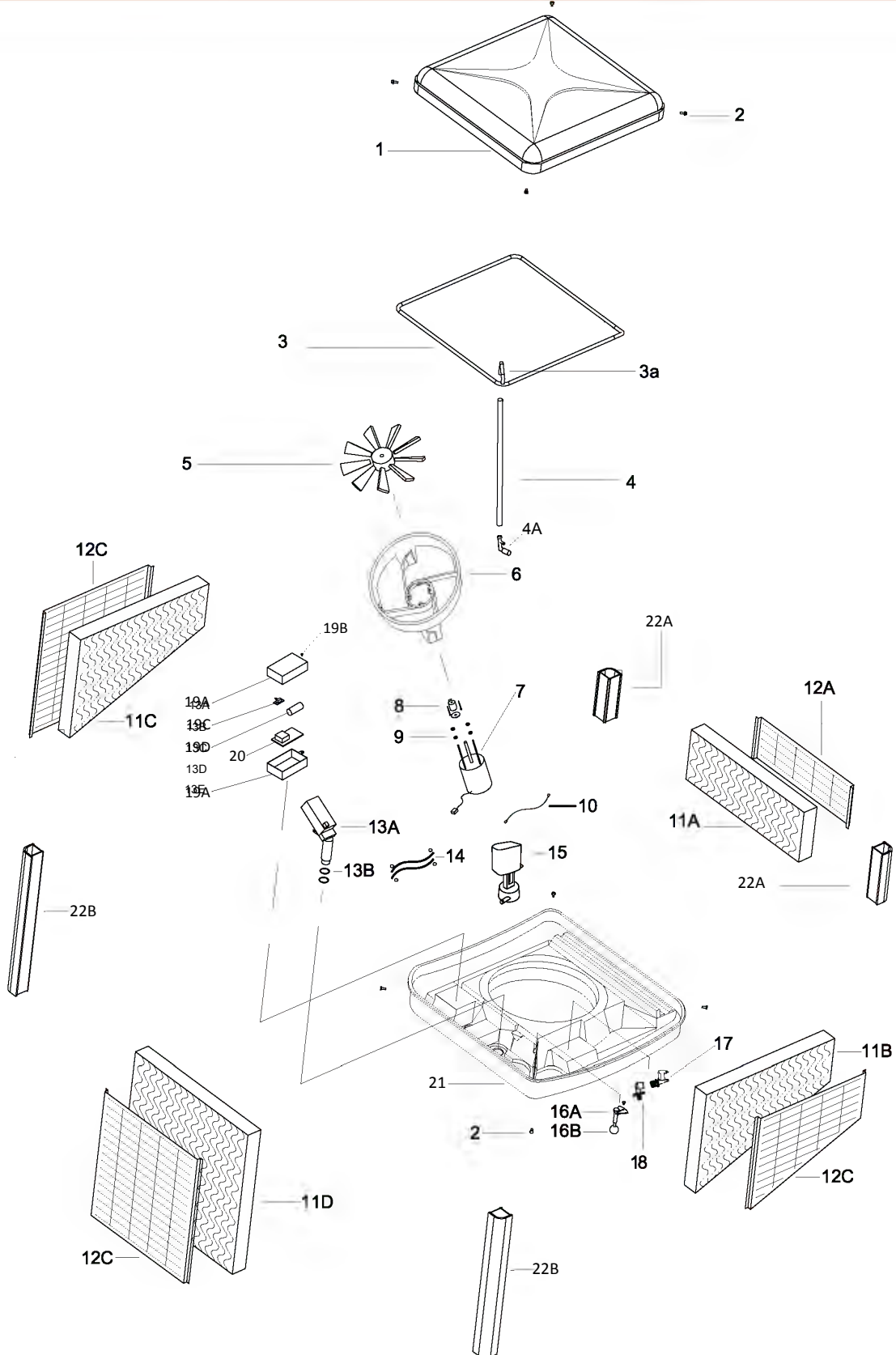

1 LID		Part No.	9 MOUNTING GROMMET SET	
C series	<i>*Specify Colour</i>	SP1010*	C series	inc. 8 grommets, washers & nuts SP6024
2 BOLT SET			10 MOTOR ANCHOR CABLE	
C series	<i>*Specify Colour</i>	SP4049*	C series	SP6048
3 MANIFOLD			11 ECOPADS FILTER PADS - set of 4 pads	Part No.
C series	Manifold Assembly	SP2007	C125	SP4312/4
A C series	Corner Repair Kit	SP2528	C160	SP4318/4
			C205	SP4324/4
			C240	SP4330/4
4 WATER RISER PIPE			12 LOUVRES - sold individually	<i>*Specify Colour</i>
C125/160	640mm long Riser Pipe	SP2110	A C160	Front Louvre (tall) SP076*
C205	760mm long Riser Pipe	SP2112	B C160	RH louvre SP078*
C240	870mm long Riser Pipe	SP2114	C C160	LH Louvre SP080*
A C series	Pump T piece	SP2043	D C160	Rear Louvre (short) SP082*
			A C205	Front Louvre (tall) SP084*
5 FAN	Motor Fan Diameter		B C205	RH louvre SP086*
C125	600W 518mm diameter Fan	SP6028	C C205	LH Louvre SP088*
C125	600W 524mm diameter Fan	SP6027	D C205	Rear Louvre (short) SP090*
C125	600W 528mm diameter Fan	SP6057	A C240	Front Louvre (tall) SP092*
C160	750W 518mm diameter Fan	SP6039	B C240	RH louvre SP094*
C160	750W 524mm diameter Fan	SP6030	C C240	LH Louvre SP096*
C160	750W 528mm diameter Fan	SP6058	D C240	Rear Louvre (short) SP098*
C205/240	1000W 518mm diameter Fan	SP6033		
C205/240	1000W 524mm diameter Fan	SP6072		
6 MOTOR RING	<i>refer page 12</i>		13 DRAIN VALVE	
2000-02	Non-Shrouded Type	SP6022	A C series	Counter-weight Drain Valve SP2040
2003 on	Shrouded Type	SP6025	B C series	Blue O ring SP2066C
7 FAN COLLET SET			14 HOSE SET - PUMP to DRAIN	
C125/160	600W & 750W motor	SP6043	C series	Hose Kit inc clamps SP2042
C205/240	1000W motor	SP6073		
8 MOTOR			15 SUPER PUMP	
C125	600W std Motor	SP6012	C series	Super Pump SP2380
C160	750W Motor	SP6014		
C205/240	1000W Motor	SP6015	16 WATER SENSOR	
C Series	Maxima Inverter Motor	SP6087	A C series	MS Water Sensor* SP2212
			B C series	MFA Magnetic Float SP2200
FAN & MOTOR PACK	inc Motor, Fan, Ring, Grommets & Collet			<i>*if unit fitted with CFRU use SP2210 - see page 13</i>
2002-06	600W std Motor (non-shrouded ring)	SP6081	17 THROUGH SUMP ELBOW	
2006 on	600W std Motor (shrouded ring)	SP6078	C series	SP2039
C125	Maxima Inverter Motor	SP6085		
2002-06	750W std Motor (non-shrouded ring)	SP6077	18 SOLENOID	
2006 on	750W std Motor (shrouded ring)	SP6076	C series	inc. solenoid, hose, clamps & cables SP2134
C160	Maxima Inverter Motor	SP6084		
2002-06	1000W std Motor (non-shrouded ring)	SP6075		
2006 on	1000W std Motor (shrouded ring)	SP6074		
C205/240	Maxima Inverter Motor	SP6086		

CONTINUED ON NEXT PAGE >

19 ELECTRICAL BOX

A	C Series	inc. box, lid, bracket & switch	SP3045
B	C Series	Plastic Bolts - pack of 4	SP3053
C	C Series	Main Switch - 240v	SP3198
D	C125	Capacitor 25uF	SP3039
D	C160-240	Capacitor 30uF	SP3040
E	C Series	Capacitor Cover	SP3042

20 MRU CIRCUIT BOARD *refer page 13*

	L or R Keypad	CFRU Board	SP3058
	QM or QA Keypad	MRU Board	SP3000
A	All except Maxima	Fuse - 15amp - Slow Blow	SP3510
	Maxima Inverter	ECRU Board	SP3011

21 SUMP**Specify Colour*

C Series	SP1007*
----------	----------------

22 CORNER POSTS**Specify Colour*

C125	Front 640mm high - 75mm pads	SP4078*
C125	Rear 275mm high - 75mm pads	SP4080*
C160	Front 640mm high - 100mm pads	SP4082*
C160	Rear 275mm high - 100mm pads	SP4084*
C205	Front 760mm high - 100mm pads	SP4086*
C205	Rear 395mm high - 100mm pads	SP4088*
C240	Front 870mm high - 100mm pads	SP4090*
C240	Rear 505mm high - 100mm pads	SP4092*

SERVICE KIT (NOT SHOWN)

C Series	inc hoses, clamps & blue O ring	SP2117
----------	---------------------------------	---------------

CABLES (NOT SHOWN)

C Series	240v Power Cable	SP3031	
C Series	Board to Motor - 6pin male - 950mm	SP6020	
C Series	Board to Controller Cable - 7pin - 15m	SP5200	
A	C Series	Corner Repair Kit	SP2528

WATER INLET TAP (NOT SHOWN)

C Series	SP2076
----------	---------------

COMMERCIAL 2000 on

TOP, SIDE & TWIN FAN UNITS

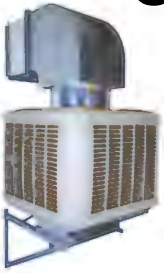

R series



2002 - 2003
SP3504

L series AUTO



2003 - 2005
SP3506



CFRU SP3510

CA MANUAL



2000 - 2002

CY MANUAL



2000 - 2002

QM MANUAL



2005 - 2016



2016 on

REPLACED BY SP3220

SP3220

CR AUTO



2000 - 2002

QA AUTO



2005 - 2016

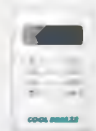

2016 on

REPLACED BY SP3221

SP3221

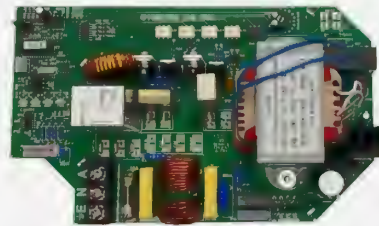

MRU SP3000

ECRU SP3011 MAXIMA
2016 on MAXIMA
inverter only

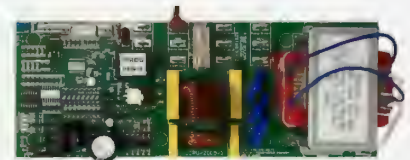

MOTOR ID

EC STD MOTORS



600W
SP6012



750w
SP6014

2000 on



1000w
SP6015

MAXIMA INVERTER MOTORS



MAXIMA series 1
replaced by SP6087









2016 - 2017



MAXIMA aeries 2
SP6087

2018 on





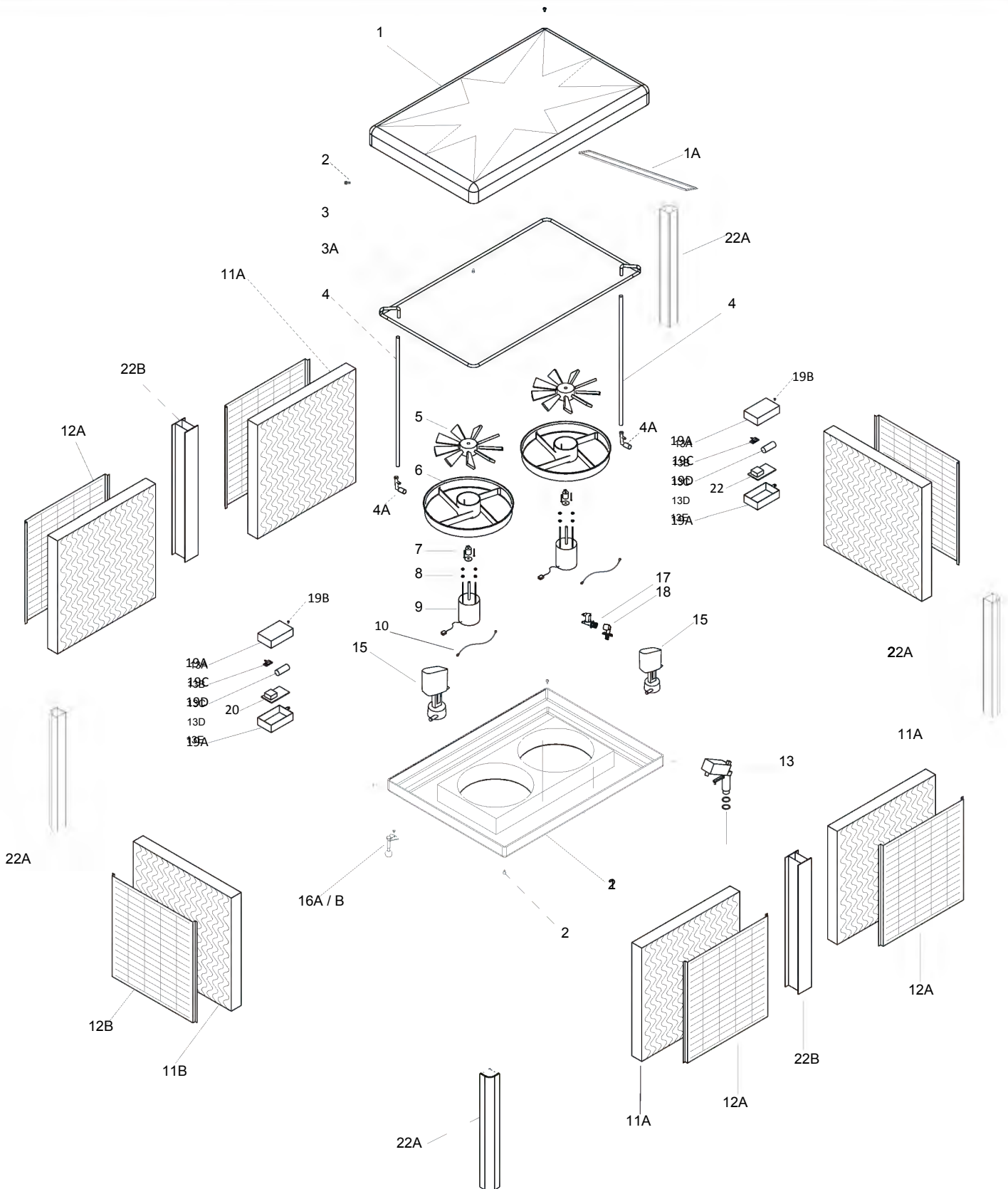



TWIN FAN D500 - 2000 on

R series		L series AUTO	CA MANUAL	CY MANUAL	QM MANUAL	CR AUTO	QA AUTO		
									
NLA	2002 - 2003	2003 - 2005	2000 - 2002	2000 - 2002	2005 - 2016	2016 on	2000 - 2002	2005 - 2016	2016 on
use SP3504	SP3504	SP3506	REPLACED BY SP3220			SP3220	REPLACED BY SP3221		SP3221
uses CFRU BOARD - SP3510			uses MRU BOARD - SP3000 (except Maxima Inverter - ECRU BOARD - SP3011)						

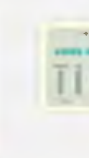

1 LID		Part No.	13 DRAIN VALVE	Part No.
D500 Lid - Beige		SP1532	D series Counter-weight Drain Valve	SP2040
A D500 Centre Support Brace		SP9612	D series Blue O ring	SP2066C
2 BOLT SET		SP4049*	14 HOSE SET - PUMP to DRAIN	
D500 Beige			D series Hose Kit inc clamps	SP2131
3 MANIFOLD		SP2530	15 SUPER PUMP	
D500 Manifold Assembly		SP2528	D series Super Pump	SP2380
A D500 Corner Repair Kit			16 WATER SENSOR	
4 WATER RISER PIPE		SP2546	A D series MS Water Sensor	SP2212
D500 1100mm long Riser Pipe		SP2043	B D series MFA Magnetic Float	SP2200
A D series Pump T piece			<i>*if unit fitted with CFRU use SP2210 - see page 13</i>	
5 FAN		SP6033	17 THROUGH SUMP ELBOW	
D500 Black Powerflow Fan		SP6072	D series	SP2039
D500 518mm diameter Fan			18 SOLENOID	
D500 524mm diameter Fan			D500 inc. solenoid, hose, clamps & cables	SP2136
6 MOTOR RING		SP6022	19 ELECTRICAL BOX	
D500 Non-Shrouded Type			A D500 inc. box, lid, bracket & switch	SP3045
7 FAN COLLET SET		SP6073	B D500 Plastic Bolts - pack of 4	SP3053
2013 on: includes collet and fixings			C D500 Main Switch - 240v	SP3198
2000-2013: Collet Set OBSOLETE - use SP6073 + SP6072			D D500 Capacitor 30uF	SP3040
8 MOUNTING GROMMET SET		SP6024	E D500 Capacitor Cover	SP3042
D500 inc. 8 grommets, washers & nuts			20 MRU CIRCUIT BOARD	<i>refer page 13</i>
9 MOTOR		SP6015	L or R Keypad CFRU Board	SP3510
D500 1000W std Motor		SP6087	QM or QA Keypad MRU Board	SP3000
D500 Maxima Inverter Motor			A All except Maxima Fuse - 15amp - Slow Blow	SP3058
FAN & MOTOR PACK - inc items 5 - 9		SP6075	Maxima Inverter ECRU Board	SP3011
D500 1000W std Motor (non-shrouded ring)		SP6094		
D500 Maxima Inverter Motor			21 SUMP	
<i>Fan mounted to motor & support ring - PLUG & PLAY</i>			D500	<i>*Specify Colour</i> SP1009*
10 MOTOR ANCHOR CABLE		SP6048	22 CORNER POSTS	
D series			D500 D500 960mm [x4] Corner Posts	SP4534
11 ECOPADS FILTER PADS - set of 6 pads		SP4548/6	D500 D500 955mm [x2] Centre Posts	SP4536
D500 Set of 6 Pads			23 CABLES (NOT SHOWN)	
12 LOUVRES - sold individually		SP0534	D series 240v Power Cable	SP3031
D500 D500 960mm [x4] - Sides		SP0535	D500 Board to Motor - 6pin male - 1.5m	SP6070
D500 D500 955mm [x2] - Ends			D series Board to Controller Cable - 7in - 15m	SP5200

TOP DISCHARGE T095 - T255 - 2000 on

R series		L series AUTO		CA MANUAL	CY MANUAL	QM MANUAL	CR AUTO	QA AUTO		
										
NLA	2002 - 2003	2003 - 2005		2000 - 2002	2000 - 2002	2005 - 2016	2016 on	2000 - 2002	2005 - 2016	2016 on
use SP3504		SP3504	SP3506		REPLACED BY SP3220		SP3220	REPLACED BY SP3221		SP3221
uses CFRU BOARD - SP3510					uses MRU BOARD - SP3000					

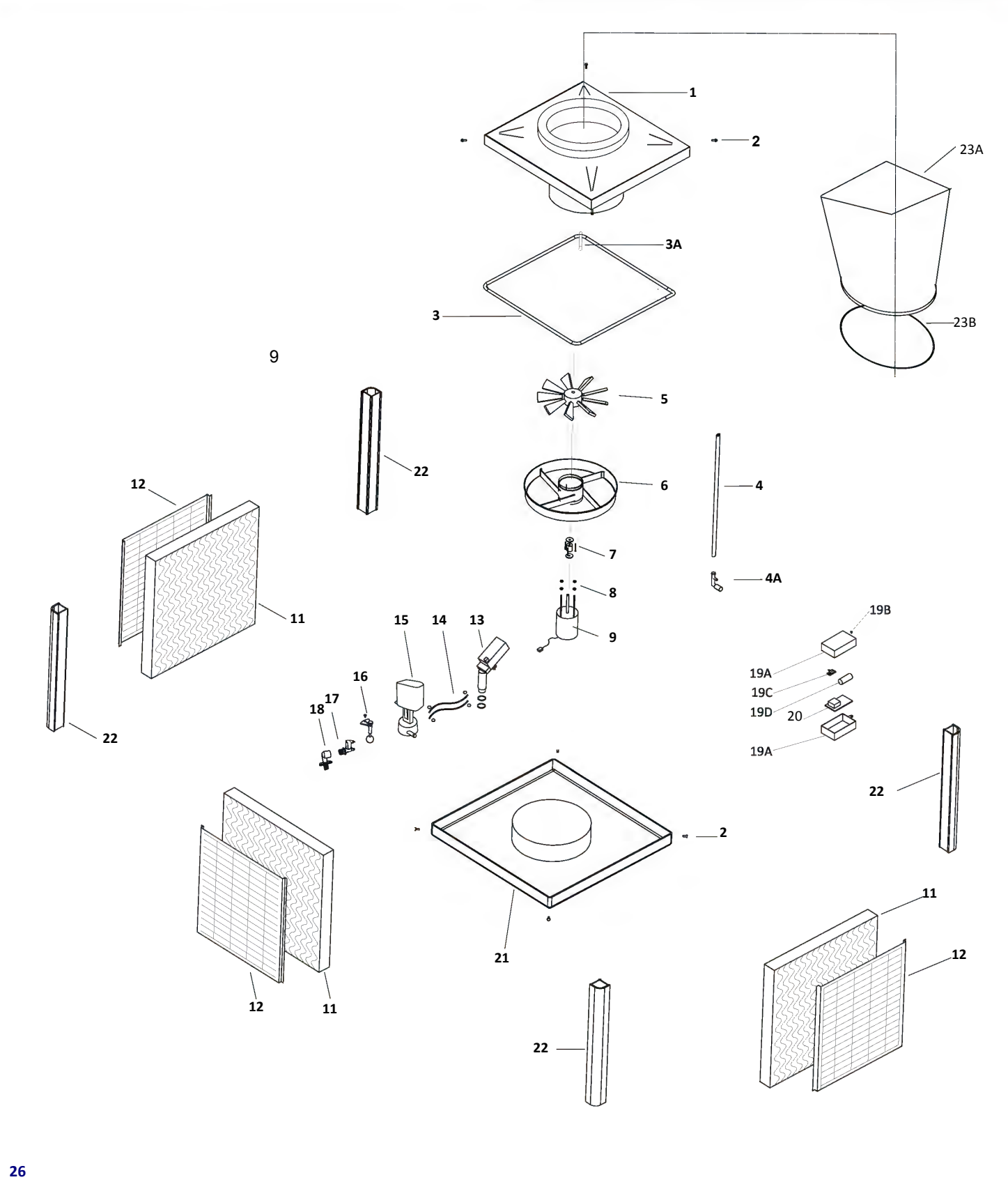

1 LID			Part No.	12 LOUVRES - sold individually		
T series		<i>*Specify Colour</i>	SP1072*	T095		SP066*
				T125/160		SP068*
				T195		SP070*
				T230		SP072*
				T255		SP074*
					<i>*Specify Colour</i>	
2 BOLT SET			SP4049*	13 DRAIN VALVE	Part No.	
T series		<i>*Specify Colour</i>		A T255	Counter-weight Drain Valve	SP2040
				B T255	Blue O ring	SP2066C
3 MANIFOLD				14 HOSE SET - PUMP to TRAIN		
T series	Manifold Assembly		SP2007	T series	Hose Kit inc clamps	SP2042
A T series	Corner Repair Kit		SP2528	15 SUPER PUMP		
				T series	Super Pump	SP2380
4 WATER RISER PIPE				16 WATER SENSOR		
T095	370mm long Riser Pipe		SP2100	A T series	MS Water Sensor	SP2212
T125/160	460mm long Riser Pipe		SP2102	B T series	MFA Magnetic Float	SP2200
T195	535mm long Riser Pipe		SP2104		<i>*if unit fitted with CFRU use SP2210 - see page 13</i>	
T230	650mm long Riser Pipe		SP2106	17 THROUGH SUMP ELBOW		
T255	770mm long Riser Pipe		SP2108	T series		SP2039
A T series	Pump T piece		SP2043	18 SOLENOID		
				T series	inc. solenoid, hose, clamps & cables	SP2134
5 FAN	Motor	Fan Diameter		19 ELECTRICAL BOX		
T095/125	600W	524mm diameter Fan	SP6027	A T series	inc. box, lid, bracket & switch	SP3045
T160	750W	524mm diameter Fan	SP6030	B T series	Plastic Bolts - pack of 4	SP3053
T195/230/255	1000W	524mm diameter Fan	SP6072	C T series	Main Switch - 240v	SP3198
				D T series	Capacitor 30uF	SP3040
				E T series	Capacitor Cover	SP3042
6 MOTOR RING		<i>refer page 12</i>		20 MRU CIRCUIT BOARD		
2000-02	Non-Shrouded Type		SP6022	QM or QA Keypad	MRU Board	SP3000
2003 on	Shrouded Type		SP6025	L or R Keypad	CFRU Board	SP3510
7 MOTOR				A T series	Fuse - 15amp - Slow Blow	SP3058
T095/125	600W std Motor		SP6012	21 SUMP		
T160	750W Motor		SP6014	T series		<i>*Specify Colour</i> SP1009*
T195/230/255	1000W Motor		SP6015			
T series	Maxima Inverter Motor		SP6087	22 CORNER POSTS		
FAN & MOTOR PACK	inc Motor, Fan, Ring, Grommets & Collet			T095	370mm high - 75mm pads	SP4066*
T095/125	600W std Motor (non-shrouded ring)		SP6081	T125	460mm high - 75mm pads	SP4068*
T160	750W std Motor (non-shrouded ring)		SP6077	T160	460mm high - 100mm pads	SP4070*
T195/230/255	1000W std Motor (non-shrouded ring)		SP6075	T195	535mm high - 100mm pads	SP4072*
	<i>Fan mounted to motor & support ring - PLUG & PLAY</i>			T230	650mm high - 100mm pads	SP4074*
8 FAN COLLET SET				T255	770mm high - 100mm pads	SP4076*
T095/125/160	600W & 750W motor		SP6043			
T195/230/255	1000W motor		SP6073			
9 MOUNTING GROMMET SET						
T series	inc. 8 grommets, washers & nuts		SP6024			
11 ECOPATS FILTER PADS - set of 4 pads						
T095	830 x 370 x 75		SP4300/4			
T125	830 x 460 x 75		SP4302/4			
T160	830 x 460 x 100		SP4304/4			
T195	830 x 535 x 100		SP4306/4			
T230	830 x 650 x 100		SP4308/4			
T255	830 x 770 x 100		SP4310/4			

SIDE DISCHARGE S240 - 2000 on







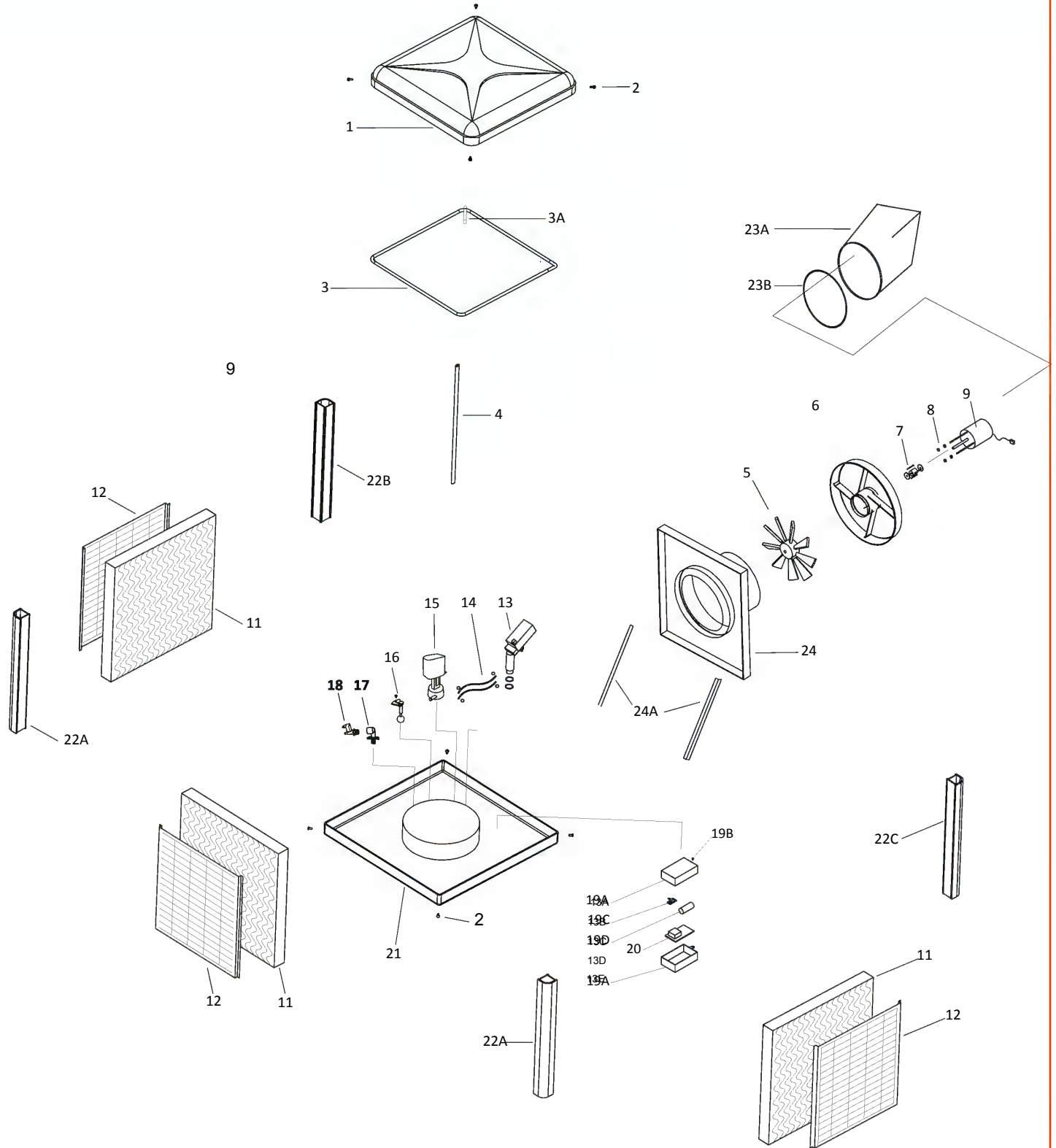



uses CFRU BOARD - SP3510

uses MRU BOARD - SP3000

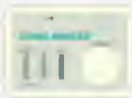

1 LID		Part No.	13 DRAIN VALVE	Part No.
S240	Beige	SP1010B	S240	Counter-weight Drain Valve
			S240	Blue O ring
2 BOLT SET		SP4049*	14 HOSE SET - PUMP to DRAIN	
S240	Beige		S240	Hose Kit inc clamps
3 MANIFOLD		SP2011	15 SUPER PUMP	SP2042
S240	Manifold Assembly	SP2528	S240	Super Pump
S240	Corner Repair Kit		16 WATER SENSOR	
4 WATER RISER PIPE		SP2096	A S240	MS Water Sensor*
S240	980mm long Riser Pipe	SP2043	B S240	MFA Magnetic Float
S240	Pump T piece			<i>*if unit fitted with CFRU use SP2210 - see page 12</i>
5 FAN	Black Powerflow Fan	SP6033	17 THROUGH SUMP ELBOW	
S240	518mm diameter Fan	SP6072	S240	
S240	524mm diameter Fan		18 SOLENOID	
6 MOTOR RING		SP6022	S240	inc. solenoid, hose, hose clamps & cables
S240	Non-Shrouded Type		19 ELECTRICAL BOX	
7 FAN COLLET SET		SP6073	A S240	inc. box, lid, bracket & switch
2013 on:	includes collet and fixings		B S240	Plastic Bolts - pack of 4
2000-2013:	Collet Set OBSOLETE - use SP6073 + SP6720		C S240	Main Switch - 240v
8 MOUNTING GROMMET SET		SP6024	D S240	Capacitor 30uF
S240	inc. 8 grommets, washers & nuts		E S240	Capacitor Cover
9 MOTOR - STD		SP6015	20 MRU CIRCUIT BOARD	
S240	1000W std Motor		QM or QA Keypad	MRU Board
FAN & MOTOR PACK - inc items 5 - 9		SP6075	L or R Keypad	CFRU Board
S240	1000W std Motor (non-shrouded ring)		A S240	Fuse - 15amp - Slow Blow
	<i>Fan mounted to motor & support ring - PLUG & PLAY</i>		21 SUMP	
11 ECOPADS FILTER PADS - set of 3 pads		SP4187/3	S240	Beige
S240	830 X 930 X 100mm		22 CORNER POSTS	
12 LOUVRES - sold individually		SP070B	A S240	Front
S240	Beige		B S240	Rear Left
			C S240	Rear Right
				<i>950mm high - 100mm pads</i>
				<i>950mm high - 100mm pads</i>
				<i>950mm high - 100mm pads</i>
CABLES (NOT SHOWN)		SP3031	23 FLEXIBLE TRANSITION SKIRT	
S240	240v Power Cable	SP6020	A S240	Flexible Connector
S240	Board to Motor - 6pin male - 950mm	SP5200	B S240	Connector Clamp
S240	Board to Controller Cable - 7in - 15m		24 MOTOR SUPPORT PANEL	
			S240	Motor Support Panel - Beige
			SERVICE KIT (NOT SHOWN)	
			S240	inc hoses, clamps & blue O ring

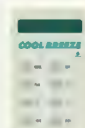
SIDE DISCHARGE S105 - 2000 on

R series			L series AUTO			CA MANUAL	CY MANUAL	QM MANUAL	CR AUTO	QA AUTO	
											
NLA	2002 - 2003	2003 - 2005	2000 - 2002	2000 - 2002	2005 - 2016	2016 on	2000 - 2002	2005 - 2016	2016 on		
use SP3504 SP3504 SP3506			REPLACED BY SP3220			REPLACED BY SP3220		REPLACED BY SP3221		REPLACED BY SP3221	
uses CFRU BOARD - SP3510						uses MRU BOARD - SP3000					

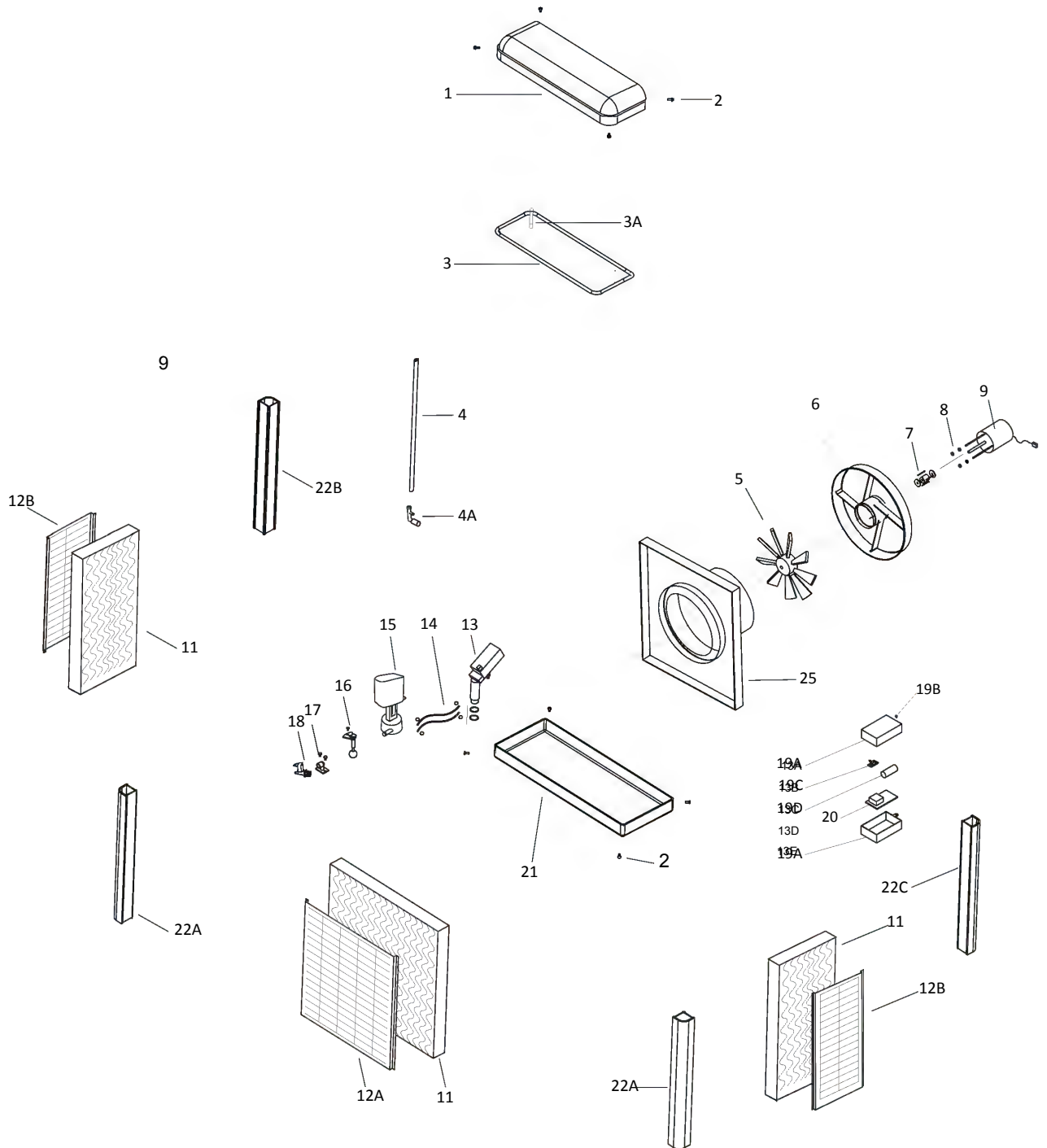

1	LID & SUMP SET - Not Available Individually	Part No.	13	DRAIN VALVE	Part No.
S105	Lid & Sump Set - Beige	SP1055	S105	Counter-weight Drain Valve	SP2040
			S105	Blue O ring	SP2066C
2	BOLT SET	SP4049*	14	HOSE SET - PUMP to DRAIN	SP2042
S105	Beige		S105	Hose Kit inc clamps	
3	MANIFOLD	SP2009	15	SUPER PUMP	SP2380
S105	Manifold Assembly	SP2528	S105	Super Pump	
S105	Corner Repair Kit		16	WATER SENSOR	
4	WATER RISER PIPE	SP2097	A	S105 MS Water Sensor*	SP2212
S105	950mm long Riser Pipe	SP2043	B	S105 MFA Magnetic Float	SP2200
A	S105 Pump T piece				<i>*if unit fitted with CFRU use SP2210 - see page 12</i>
5	FAN	SP6028	17	THROUGH SUMP ELBOW	SP2039
S105	Grey Fan Green Hub	SP6027	S105		
S105	518mm diameter Fan		18	SOLENOID	SP2134
S105	524mm diameter Fan		S105	inc. solenoid, hose, hose clamps & cables	
6	MOTOR RING	SP6022	19	ELECTRICAL BOX	
S105	Non-Shrouded Type		A	S105 inc. box, lid, bracket & switch	SP3045
7	FAN COLLET SET	SP6073	B	S105 Plastic Bolts - pack of 4	SP3053
S105	includes collet and fixings		C	S105 Main Switch - 240v	SP3198
8	MOUNTING GROMMET SET	SP6024	D	S105 Capacitor 25uF	SP3039
S105	inc. 8 grommets, washers & nuts		E	S105 Capacitor Cover	SP3042
9	MOTOR - STD	SP6012	20	MRU CIRCUIT BOARD	SP3000
S105	600W std Motor			QM or QA Keypad MRU Board	SP3510
FAN & MOTOR PACK - inc items 5 - 9		SP6081		L or R Keypad CFRU Board	
S105	600W std Motor Pack		A	S105 Fuse - 15amp - Slow Blow	SP3058
	<i>Fan mounted to motor & support ring - PLUG & PLAY</i>		22	CORNER POSTS	
11	ECOPADS FILTER PADS	SP4186	A	S105 Front 950mm high - 100mm pads	SP4061
S100	1997-2002 Front - 840x930x75*	SP4188	B	S105 Rear Left 950mm high - 100mm pads	SP4059
S100	1997-2003 Side - 275x930x75*		C	S105 Rear Right 950mm high - 100mm pads	SP4057
	<i>S100 pads sold individually *made to order</i>		23	MOTOR SUPPORT PANEL	SP1059
S105	2003 on - Set of 3 pads	SP4190/3	S105	Side Panel - Beige	
12	LOUVRES - sold individually	SP063B	24	CABLES (NOT SHOWN)	SP3031
S105	Front - Beige	SP065B	S105	240v Power Cable	SP6020
S105	Side - Beige		S105	Board to Motor - 6pin male - 950mm	SP5200
			S105	Board to Controller Cable - 7in - 15m	

MOBILE UNITS 2000 on

M200 GREY: 2000 - 2003 - 75mm FILTER PADS

M240 BLUE: 2004 - 2020 - 100mm FILTER PADS

M240WC RED or BLUE: 2020 on - 100mm FILTER PADS



WALL CONTROLLERS



2000 - 2003



2004 - 2019



2020 on
SP3221

MOTOR ID

EC STD MOTORS



1000w
SP6015
2000 on

CIRCUIT BOARDS



SP3013
2000 - 2019



MRU SP3000
2020 on

PUMP ID



SP2035
2000 - 2019



SP2380
2020 on

CONTROLLER

ROTARY CONTROLLER



2000 - 2002



2003 - 2019

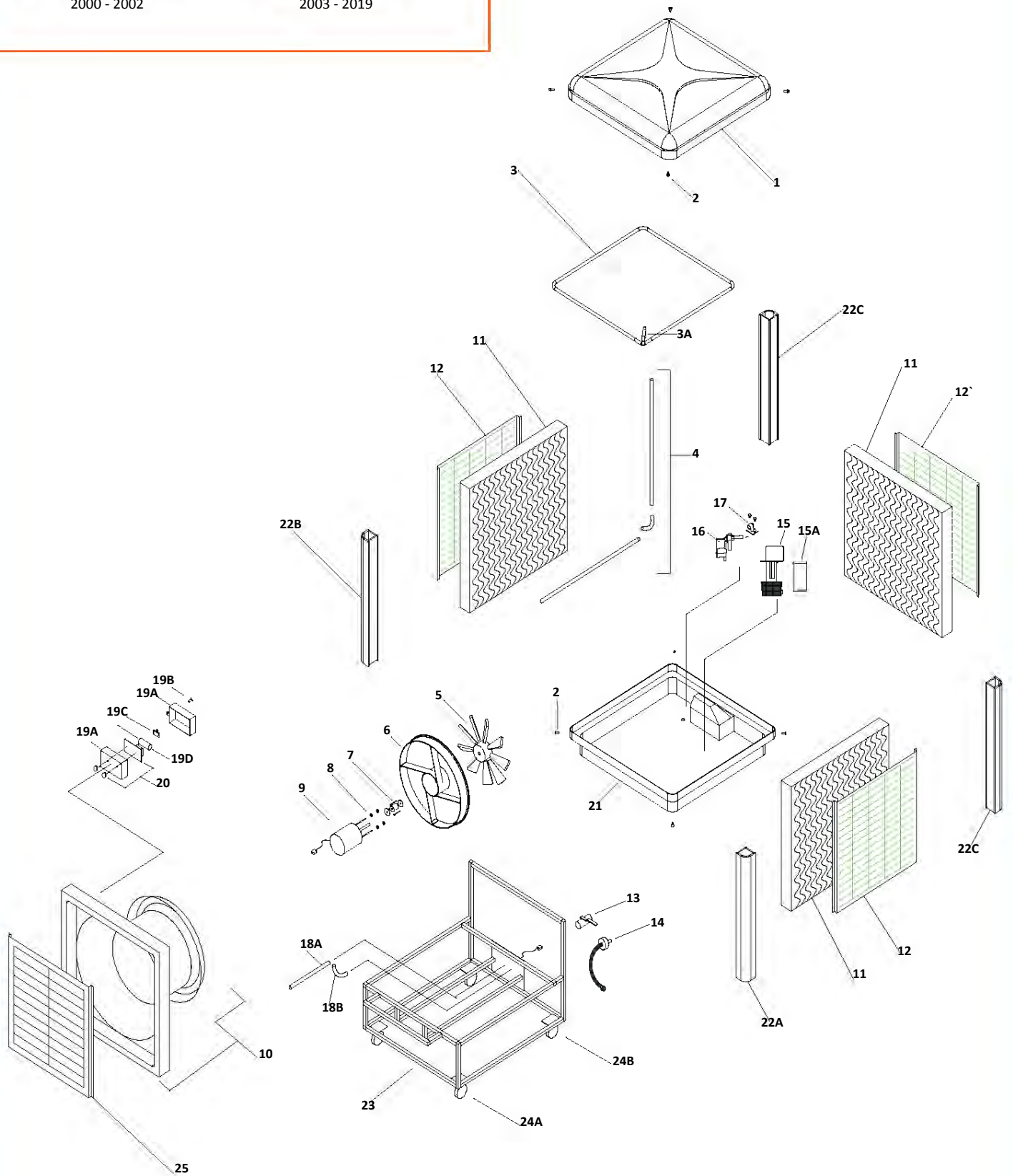

1 LID			Part No.	13 DRAIN TAP	Part No.
M200	2000-2002	Grey Lid	SP1010Y	A M200/240	SP2145
M240	2003-2019	Lid - specify Red or Blue	SP1010U		
2 BOLT SET				14 INLET HOSE - with CLICK-ON FITTING	
M200		Grey Bolt Set	SP4049Y	M200/240	Braided Hose inc. click-on fitting
M240		Blue Bolt Set	SP4049U		SP2140
3 MANIFOLD				15 PUMP	
M200/240		Manifold Assembly	SP2011	A M200/240	Long Shaft Pump
M200/240		Corner Repair Kit	SP2528	B M200/240	Pump Bracket
					SP2035
					SP2128
4 WATER RISER PIPE				16 FLOAT ASSEMBLY	
M200/240		Riser Pipe Set	SP2116	M200/240	Fluidmaster Float Valve
					SP2027
5 FAN		Black Powerflow Fan		17 ELBOW	
M200/240		524mm diameter Fan	SP6072	M200/240	Elbow
					SP2039
6 MOTOR RING				18 DRAIN HOSE	
M200/240		Non-Shrouded Type	SP6022	A M200/240	Drain Hose
				B M200/240	Drain Hose Elbow
					SP2141
					SP2017
7 FAN COLLET SET				19 ELECTRICAL BOX	
M200/240		includes collet and fixings	SP6073	A M200/240	Box & Cover
				B M200/240	Main Switch - 240v
				C M200/240	30uF Capacitor & Cover
					SP3051
					SP3198
					SP3040
8 MOUNTING GROMMET SET				20 CIRCUIT BOARD	
M200/240		inc. 8 grommets, washers & nuts	SP6024	M200/240	PCB Board inc 2 x Knobs
					SP3013
9 MOTOR - STD				21 SUMP	
M200/240		1000W std Motor	SP6015	M200/240	Blue only available - Grey Sump NLA
		FAN & MOTOR PACK - inc items 5 - 9			SP1081
M200/240		1000W std Motor	SP6075		
		<i>Fan mounted to motor & support ring - PLUG & PLAY</i>			
10 FRONT PANEL				22 CORNER POSTS - sold individually	
M200/240		Front Panel & Motor Cowl	SP1061	M200	2000-02 - 75mm - Grey
				A M240	Front RH - 100mm pads - Blue
				B M240	Front LH - 100mm pads - Blue
				C M240	Rear - 100mm - Blue (x2)
					NLA
					SP4067U
					SP4065U
					SP4063U
11 ECOPADS FILTER PADS - set of 3 pads				24 CASTERS	
M200	2000-02	75mm Thick*	SP4189	A M200/240	Fixed Caster - no brake
		* Sold Individually		B M200/240	Swivel Caster - braked
M240	2003-20	100mm Thick - set of 3 pads	SP4187/3		SP9605
					SP9604
12 LOUVRES - sold individually				25 FRONT GRILLE PANEL	
M200	2000-02	Grey Louvre	NLA	M200/240	Grille Panel - Blue* only available
M240	2003-20	Blue Louvre	SP063U		*Grey Front Panel NLA
		use Blue			SP9609

WHEELIE COOL M240WC: 2020 on [BLUE or RED]

CONTROLLER

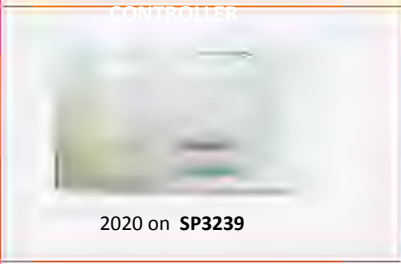

2020 on SP3239

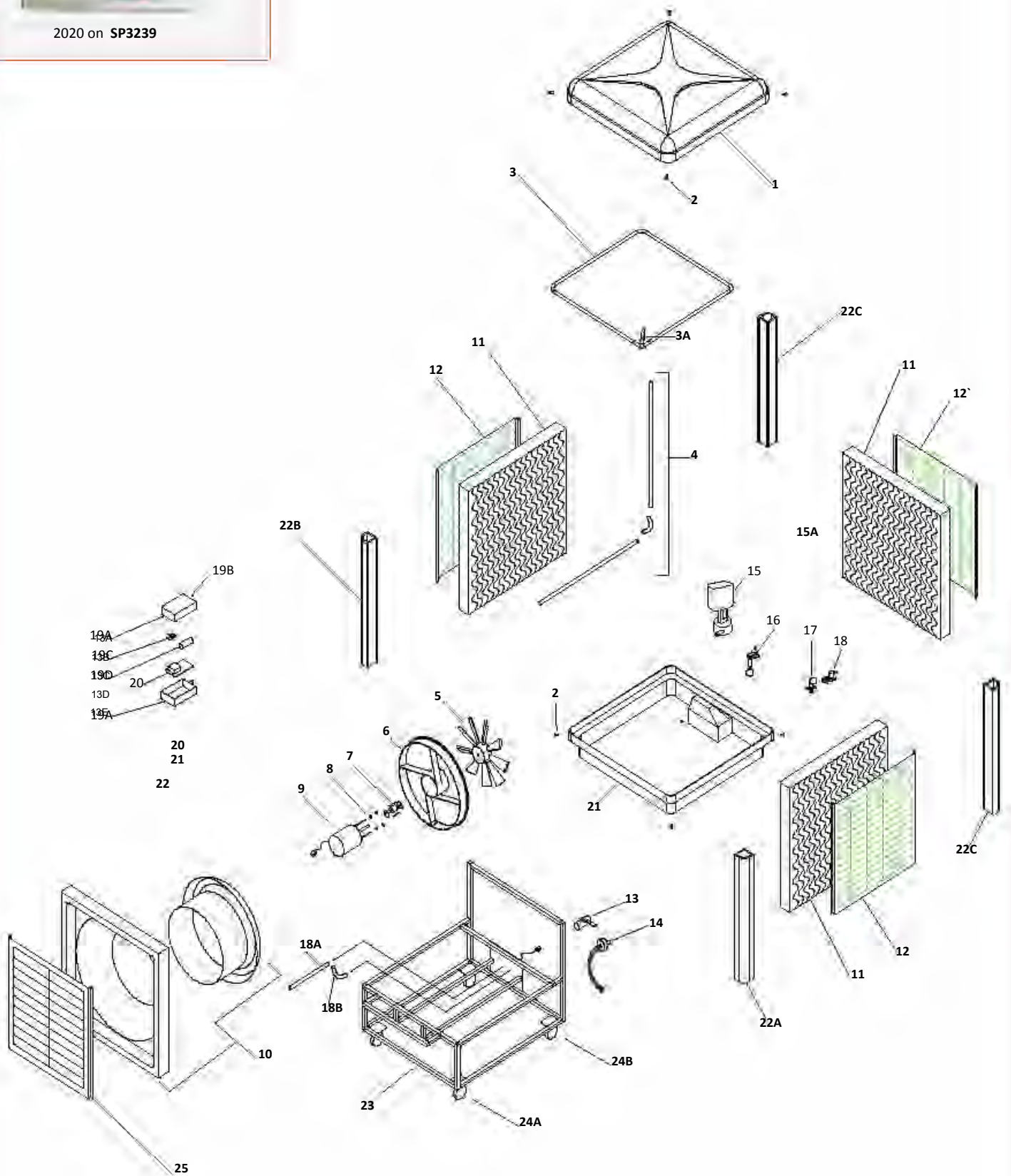

1 LID	M240WC	Blue Lid	SP1010U	13 DRAIN TAP	A M240WC	SP2145
	M240WC	Red Lid	SP1010R	14 INLET HOSE - with CLICK-ON FITTING	M240WC	Braided Hose inc. click-on fitting SP2140
2 BOLT SET	M240WC	Blue Bolt Set	SP4049U	15 PUMP	M240WC	Superpump w/long lead SP2036
	M240WC	Red Bolt Set	SP4049R	16 FLOAT ASSEMBLY	M240WC	MS Water Sensor SP2212
3 MANIFOLD	M240WC	Manifold Assembly	SP2011	17 ELBOW	M240WC	Elbow SP2017
	M240WC	Corner Repair Kit	SP2528	18 DRAIN HOSE	A M240WC	Drain Hose SP2141
4 WATER RISER PIPE	M240WC	Riser Pipe Set	SP2116		B M240WC	Drain Hose Elbow SP2017
5 FAN	M240WC	Black Powerflow Fan 524mm diameter Fan	SP6072	19 ELECTRICAL BOX	A M240WC	inc. box, lid, bracket & switch SP3045
6 MOTOR RING	M240WC	Non-Shrouded Type	SP6022		B M240WC	Plastic Bolts - pack of 4 SP3053
7 FAN COLLET SET	M240WC	includes collet and fixings	SP6073		C M240WC	Main Switch - 240v SP3198
8 MOUNTING GROMMET SET	M240WC	inc. 8 grommets, washers & nuts	SP6024		D M240WC	Capacitor 30uF SP3040
9 MOTOR - STD	M240WC	1000W std Motor	SP6015		E M240WC	Capacitor Cover SP3042
FAN & MOTOR PACK - inc items 5 - 9	M240WC	1000W std Motor (non-shrouded ring)	SP6075	20 CIRCUIT BOARD	M240WC	MRU Board SP3000
		<i>Fan mounted to motor & support ring - PLUG & PLAY</i>			A M240WC	Fuse - 15amp - Slow Blow SP3058
10 FRONT PANEL	M240WC	Front Panel & Motor Cowl	SP1062*	21 SUMP	M240WC	*specify colour SP1081*
		specify colour		22 CORNER POSTS	A M240WC	Front RH - 100mm pads SP4067
11 ECOPADS FILTER PADS - set of 3 pads	M240WC	100mm Thick	SP4187/3		B M240WC	Front LH - 100mm pads SP4065*
12 LOUVRES - sold individually	M240WC	Louvres	SP063*		C C240	Rear - 100mm SP4063*
		*specify colour				*specify colour
				24 CASTERS	A M240WC	Fixed Caster - no brake SP9605
					B M240WC	Swivel Caster - braked SP9604
				25 FRONT GRILLE PANEL	M240WC	Grille Panel - Blue SP9609
					M240WC	Grille Panel - Black SP9609E

COOLBREEZE SPARE PARTS CATALOGUE

RESIDENTIAL, COMMERCIAL & MOBILE UNITS
DOWN, SIDE & TOP DISCHARGE MODELS

MANIFOLDS & SOLENOIDS	40
FLOATS & PUMPS	41
DRAINS & VALVES	42
MOTORS & CAPACITORS	43
FANS & MOTOR PACKS	44
CABLES	45
CIRCUIT BOARDS	46
CONTROLLERS & KEYPADS	47
CORNER POSTS	48
SUMPS & LIDS	49
LOUVRES - SPRAY PAINT	50
ZONE SYSTEMS & MOTORS	51
ECOPADS FILTER PADS	
CoolBreeze	53-55
Ezycool	55
Comfort Breeze	56
Breezair	57
Braemar	57
Coolair	57
Bonaire	57

MODEL SIZE ID CHART

Count the number of rows of louvres on one side



No of Rows of Louvres	Model	Year	Motor	Filter Pad Sizes		
				Width	Height	Thickness
7 rows	D095	2000 on	600w	830 x	370 x	75
9 rows	105	pre 2000	600w	735 x	400 x	75
10 rows	D125	2000 on	600w	830 x	460 x	75
10 rows	D160	2000 on	750w	830 x	460 x	100
12 rows	130	pre 2000	600w	735 x	495 x	75
12 rows	160	pre 2000	750w	840 x	495 x	75
12 rows	D195	2000 on	1000w	830 x	535 x	100
15 rows	D230	2000 on	1000w	830 x	650 x	100
17 rows	185	pre 2000	1000w	840 x	630 x	75
19 rows	D255	2000 on	1000w	830 x	770 x	100
20 rows	210	pre 2000	1000w	840 x	730 x	75

CASCADE MODELS

Count the number of rows of louvres on the front



15 rows	C125	2000 on	600w	830 x	640 x	75
15 rows	C160	2000 on	750w	830 x	640 x	100
19 rows	C205	2000 on	1000w	830 x	760 x	100
22 rows	C240	2000 on	1000w	830 x	870 x	100

Manifolds & Solenoids

NLA = No Longer Available

MANIFOLDS



SP2002	80-130	1997-2000	
SP2007	Heritage/Casc./T ser.		
SP2009	S105		
SP2011	S240/M240		
SP2530	D500		
SP2602	Ezycool 01-10 Vert.		NLA
SP2604	Ezycool 01-10 Sloping		NLA

WATER FEED RISER PIPE



SP2100	D095	370mm
SP2102	D125/160	460mm
SP2104	D195	535mm
SP2106	D230	650mm
SP2108	D255	770mm
SP2110	C125/160	640mm
SP2112	C205	760mm
SP2114	C240	870mm

WATER FEED RISER PIPE



SP2096	S200/240	980mm
SP2097	S105	950mm
SP2513	U/EX Series	850mm
SP2620	L110	1000mm*
SP2546	D500	1100mm*
SP2116	M240	960mm

**cut to length*

MANIFOLD REPAIR KIT all models except S105



SP2528	Corner Repair Kit
SP2043	Pump T piece

THROUGH SUMP ELBOW



Elbow & Bracket - inc. O-ring	
SP2039	Through Sump Elbow

SOLENOIDS



SP2640	suits Hydraulic Drain Valve
--------	-----------------------------

SOLENOIDS Suits electric drain valve



Threaded connections both sides inc cables	
SP2135	Solenoid - Threaded

SOLENOIDS 2002 on ALL MODELS (except Twin Fan)

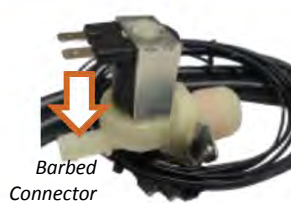

24v Barbed Solenoid Kit inc hose & 4 x clips & cables	
SP2134	Barbed Solenoid

SOLENOIDS D500 TWIN FAN & M240WC



24v Barbed Solenoid Kit inc hose & 4 x clips & cables	
SP2136	Barbed Solenoid - D500 to suit D500 & M240WC models

SOLENOIDS ***While Stocks Last*** 1991 - 1993 24v RETRO FIT KIT



inc. Transformer & Solenoid RPE-filter	
SP2057	Retro Fit Kit

Water Float & Pumps

* = Subject To Stock Availability NLA = No Longer Available

FLUIDMASTER 703 FLOAT VALVE



CZ/CO/MX 1994-2000 160-250 models

SP2654 Float Valve **NLA**
Replace with SP2027

FLUIDMASTER FLOAT VALVE M240 MOBILE UNIT



also: 1994-2000 CO / MX
2002-02 E series

SP2027 M240 Fluidmaster Float Valve

DIAPHRAGM Fluidmaster High Pressure



SP2078 Diaphragm
Suitable for Fluidmaster 703 only

90deg. BARBED DRAIN ELBOW M240 MOBILE UNIT



SP2017 Drain Elbow

19mm RESTRICTOR TAP



SP2010 Restrictor Tap

WATER INLET VALVE



SP2076 Inlet Tap

WATER LEVEL SENSOR Magnetic Water Level Sensor - MWL



Screw type connectors
suits units with CFRU board only - refer page 13
SP2210

WATER LEVEL SENSOR Magnetic Water Level Sensor - MS



3 Core Cable with Single
suits units with MRU board only - refer page 13
SP2212

WATER LEVEL SENSOR Magnetic Float Assembly - MFA



Compatible with MWL & MS sensors
SP2200

SUPER PUMP



SP2380 Super Pump
SP2380/8 Carton of 8*
SP2380/240 Pallet of 240*

SUPER PUMP M240WC MOBILE ONLY



SP2036 Pump with LONG cable
suits 2020 on M240WC mobile unit only

QUIETFLO PUMP M240 MOBILE UNIT



Long Shaft with Bracket
SP2035 M240 Mobile Unit
SP2128 S/Steel Support Bracket

< SP2128

* = Subject To Stock Availability NLA = No Longer Available

EZYCOOL DRAIN VALVE KIT 2016 on



inc. washer, hoses,
clips & T piece

SP2132 Ezycool Drain Valve Kit

COUNTER-WEIGHT DRAIN VALVE 2002 ON



SP2040 Drain Valve - Black
SP2040/10 Pack of 10 Drain Valves*

ELECTRIC DRAIN VALVE pre 2001



SP2062 Electric Drain Valve **NLA**
USE SP2082 BLEED TRAY

HYDRAULIC DRAIN VALVE



SP2064 Hydraulic Drain Valve

ELBOW suits Hydraulic Drain Valve



SP2065 Elbow - brass fitting
SP2069 Elbow - top of valve

BLEED OFF TRAY



includes fitting
SP2082 Bleed Off Tray

SERVICE MAINTENANCE KIT 2001 on



inc. Hoses, Clips
& Blue O ring

SP2117 Service Kit
SP2117/20 Pack of 20 Kits

HOSE KIT



Counter-weight Drain Valve hose
SP2042 Hose Kit
SP2131 Hose Kit - D500

HOSE suits Hydraulic Drain Valve



Between Hydraulic Drain Valve
and Brass adaptor - 6mm Hose
SP2067 6mm Hose

O RING



SP2066 Sq. section O ring
SP2068 Round section O ring

O RING



SP2066C Blue O ring
SP2066C/20 Pack of 20 Blue O-rings

DRAIN FITTINGS



SP2072 40mm female
SP2073 40mm to 19mm

* = Subject To Stock Availability NLA = No Longer Available

MOTORS



includes Capacitor Kit
[collet not included]

- SP6012 600w Motor
- SP6014 750w Motor
- SP6015 1000w Motor

MOTORS - BULK BUY 10 PACK



includes Capacitor Kit
[collet not included]

- SP6012/10** 10 x 600w Motor*
- SP6014/10** 10 x 750w Motor*
- SP6015/10** 10 x 1000w Motor*

MAXIMA INVERTER MOTOR 2016 on



SP6087 Inverter Motor

When replacing Maxima series 1 motor also requires SP6089 Motor to ECRU cable

CAPACITORS 25uF



inc. cover
suits 600w motors

SP3039 25uF Capacitor
& Cover

CAPACITORS 30uF



inc. cover
suits 750w & 1000w motors

SP3040 30uF Capacitor
& Cover

MOTOR ANCHOR CABLE



SP6048 Motor Anchor Cable

COLLETS 1992 on 600w & 750w motors



Fan collet and bolt fixing pack
suits Grey 10 blade fans

SP6043 600/750w Collet Set

COLLETS 2013 on 1000w motors



Fan collet and bolt fixing pack
suits Black 9 blade Powerflow fans

SP6073 1000w Collet Set
Not compatible with SP6031 fan

MOTOR MOUNTING GROMMETS



SP6024 Motor Grommet Pack

MAXIMA INVERTER UPGRADE KIT 2016 on



SP6087

SP6079 Maxima Retro Kit
Also requires SP6087 Maxima motor (sold separately)

Fans & Motor Packs



Non-Shrouded Motor Ring -
fan is above
the ring



Shrouded Motor Ring -
fan is inside the ring

*Non-shrouded motor ring fitted to:
Twin Fan, Side Discharge & M240*

MOTOR PACK - SHROUDED



inc. Motor, Fan, Collet, Capacitor & Cover

- SP6078 600w Motor Pack
- SP6076 750w Motor Pack
- SP6074 1000w Motor Pack

MOTOR PACK - NON SHROUDED



inc. Motor, Fan, Collet, Capacitor & Cover

- SP6081 600w Motor Pack
- SP6077 750w Motor Pack
- SP6075 1000w Motor Pack

MOTOR PACK - SHROUDED MAXIMA INVERTER



inc. Motor, Fan, Collet

- SP6085 600w Motor Pack
- SP6084 750w Motor Pack
- SP6086 1000w Motor Pack

MOTOR RING - SHROUDED



2002 on D095-255
2006 on Cascade

- SP6025 Shrouded Motor Ring

MOTOR RING - NON SHROUDED



All D400/500, S105, S240 & M240
2000-02 D095-255 & 02-06 Cascade

- SP6022 Non-shrouded Motor Ring

MOTOR PACK - NON-SHROUDED MAXIMA INVERTER



D500 Maxima Inverter

- SP6094 D500 Maxima Motor Pk

FANS - 10 blade Green Hub



suits 600w motors & S100

- SP6028 518 mm diameter
- SP6027 524 mm diameter
- SP6057 528 mm diameter

FANS - 10 blade Grey Hub



suits 750w motors & S105

- SP6039 518 mm diameter
- SP6030 524 mm diameter
- SP6058 528 mm diameter

FANS - 9 blade Black Powerflow



suits 1000w motors

- SP6033 518 mm diameter
- SP6072 524 mm diameter
- SP6059 528 mm diameter

CABLE - MRU to MOTOR 2000 on



*Motor Extension Cable
w/6 pin male connector*
SP6020 Cable - 950mm

CABLE - MRU to MOTOR D400/500 Twin Fan - 2000 on



*Motor Extension Cable
suits D400/500 Twin Fan models*
SP6070 Cable - 1500mm

MAIN POWER CABLE



SP3031 Main 240v Power Lead

CABLE - ROOF UNIT TO KEYPAD SUITABLE FOR 19mm CONDUIT



12m X 7 core cable
7 pin to - 1x3 & 1x4 pin terminals
SP5212 12m x 7core cable

MRU to CONTROLLER CABLE



15m X 7 core cable
w/ 2x Female Connectors
SP5200 Cable - MRU to
to Controller

MRU to CONTROLLER 10m EXTENSION CABLE



10m X 7 core cable
1x Female & 1x Male Connector
SP5206 Ext. Cable - 10m

MRU to CONTROLLER 50m EXTENSION CABLE



10m X 7 core cable
1x Female & 1x Male Connector
SP5207 Ext. Cable - 50m

CABLE - ECRU to MOTOR MAXIMA INVERTER



Euro-Maxima Series II
SP6089 Motor Ext. Cable

CABLE - ECRU to MOTOR D500 MAXIMA INVERTER



D500 Maxima Series II
SP6090 Motor Ext. Cable

TEST CABLE - CONTROLLER



1000mm long - 7 core cable
2 x Female Connectors
SP5218 Test Cable

MRU to MUCS BOARD CABLE - D400/500 TWIN FAN UNITS



250mm long - 7 core cable
2 x Female Connectors
SP5224 MRU to MUCS Cable
D400/500 only

MRU to MUCS BOARD CABLE - D400/500 TWIN FAN UNITS



3.2m long - 7 core cable
2 x Female Connectors
SP5223 MRU to MUCS Cable
D400/500 only

* = Subject To Stock Availability NLA = No Longer Available

CIRCUIT BOARDS MRU



suits QA, QM & M240WC
(use to replace CO/CR with QA/M)
SP3000 MRU - Circuit Board*

CIRCUIT BOARDS CFRU



CFRU - F & FC series
suits L & R controllers
SP3510

CIRCUIT BOARDS M240 2002 on



suits M240 up to 2019 (2020 on uses SP3000)
inc. Rotary Controls and Knobs
SP3013 M240 Circuit Board

CIRCUIT BOARDS



Neatrol Roof Unit Board
SP3005 Neatrol Board
While Stocks Last

CIRCUIT BOARDS



ECRU - Maxima Inverter Roof Unit
Board - suits QA/M controller
SP3011 QA/M Maxima Board

CIRCUIT BOARDS MUCS - MULTI UNIT CONTROL SYSTEM



Controls up to 99 units from one keypad
suits Single Fan Units only
SP3008 MUCS board
Single Fan units only

CIRCUIT BOARDS MUCS - MULTI UNIT CONTROL SYSTEM



Controls up to 99 units from one keypad
suits d400/500 Twin Fan Units only
SP3007 MUCS board - D500
Twin Fan units only

SLOW BLOW FUSES MAIN SWITCH



SP3052 5amp Fuses (5 pack)
SP3058 15amp Fuses (5 pack)
SP3198 Switch

MRU BOX All Down, Side, Top Discharge & M240WC

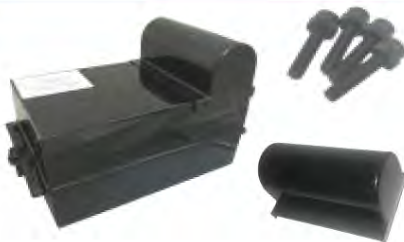

inc: Lid, cable bracket
& isolator switch
SP3045 MRU Box
SP3053 Plastic Bolts (pack of 4)
SP3042 Capacitor Cover

ELECTRICAL BOX & LID M240 - 2006-2019



No on/off switch
Holes pre-drilled for switch
SP3051 Box & Lid

CFRU BOX 2003-2017



inc: Lid, cable bracket
& isolator switch
SP3530 CFRU Box

NLA = No Longer Available

CONTROLLERS 2005 on QM



suits MRU & ECRU board
SP3220 QM controller

CONTROLLERS 2005 on QA



suits MRU & ECRU board
SP3221 QA controller

M240WC WHEELIE COOL CONTROLLER 2020 on



suits MRU board
SP3239 M240WC Controller

CONTROLLERS L series



suits CFRU board
SP3506 L series Controller
SP3517 L series Overlay

CONTROLLERS R series



Replaces Controller w/2x Knobs
suits CFRU board
SP3504 R series Controller

OVERLAYS CR

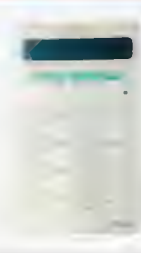

suits MRU board
SP3518 CR Overlay *No Longer Available*

OVERLAYS QM 2005-2016



suits MRU board
SP3515 old QM overlay

OVERLAYS CY series



suits MRU board
SP3516 CY overlay

OVERLAYS QA 2005 - 2016



suits MRU board
SP3514 old QA overlay

CM/CF TO QM CONVERSION KIT



SP3156 Conversion Kit
inc: Cables, MRU & Box, QM keypad

CONTROLLER EZYCOOL 2016 ON



suits MRU board
SP3201 EM controller

MX CONTROLLER 1993-1998



suits MRU board
SP3222 MX Controller
while stock lasts

Note: Colours may vary slightly to original for pre-2000 models

CORNER POSTS 1994 - 2000



Posts Sold Individually
Made to Order

SP4036*	80	330mm [75]
SP4038*	105	420mm [75]
SP4040*	130	515mm [75]
SP4042*	160	650mm [75]
SP4044*	185	650mm [75]
SP4046*	210	750mm [75]
SP4062*	250	950mm [75]

*Specify colour

CORNER POSTS HERITAGE 2000 on



Posts Sold Individually

SP4066*	D095	370mm [75]
SP4068*	D125	460mm [75]
SP4070*	D160	460mm [100]
SP4072*	D195	535mm [100]
SP4074*	D230	650mm [100]
SP4076*	D255	770mm [100]

*specify colour

CORNER POSTS CASCADE 2000 on



Posts Sold Individually

SP4078*	C125	640mm Front
SP4080*	C125	275mm Rear
SP4082*	C160	640mm Front
SP4084*	C160	275mm Rear
SP4086*	C205	760mm Front
SP4088*	C205	395mm Rear
SP4090*	C240	870mm Front
SP4092*	C240	505mm Rear

CORNER POSTS - SIDE & TOP S105 / S240



Posts Sold Individually

SP4061	S105	930mm Front
SP4059	S105	930mm LHR
SP4057	S105	930mm RHR
SP4093	S240	950mm LHR
SP4094	S240	950mm RHR
SP4095	S240	950mm Front

CORNER POSTS D400 / D500 TWIN FAN



Posts Sold Individually

SP4534	D500	960mm [x4]
SP4536	D500	955mm [x2]

CORNER POSTS M240 MOBILE



Posts Sold Individually

2000-2002	75mm Pads
SP4062GY	M240 - Grey
2003 on	100mm Pads
SP4065*	M240 LH Front Post
SP4067*	M240 RH Front Post
SP4063*	M240 Rear Post [x2]

*specify colour

BOLT PACKS



SP4048	Bolt Pack pre-2000
SP4049*	Bolt Pack 2000 on
	*specify colour
SP4564	Bolt Pack - D500

WINTER PANELS pre-2000

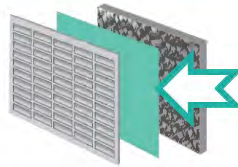

Made to Order		
Set of 4	Model	Size
SP1615*	80	735 x 310
SP1616*	105	735 x 400
SP1617*	130	735 x 495
SP1618*	160	840 x 495
SP1619*	185	840 x 630
SP1620*	210	840 x 730
SP1621*	250	840 x 930

*specify colour

WINTER PANELS 2000 on

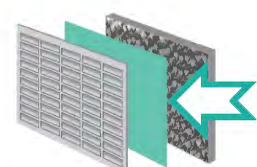

Made to Order		
Set of 4	Model	Size
SP1622*	D095	825 x 330
SP1623*	D125	825 x 420
SP1623*	D160	825 x 420
SP1624*	D195	825 x 490
SP1625*	D230	825 x 610
SP1626*	D255	825 x 720
SP1627*	C125	
SP1627*	C160	
SP1628*	C205	
SP1629*	C240	

*specify colour

Note: Colours may vary slightly to original for pre-2000 models NLA = No Longer Available

LIDS & SUMPS 1994 - 2000



Made to Order

SP1006B Lid - Small
** Beige Only**
Sump - No longer available

LIDS & SUMPS HERITAGE 2000 on



*specify colour

SP1010* Lid - Heritage
SP1009* Sump - Heritage

LIDS & SUMPS CASCADE 2000 on



*specify colour

SP1010* Lid - Cascade
SP1007* Sump - Cascade

LIDS, SUMP & SIDE PANELS S240



LIDS, SUMP & SIDE PANELS

S240 Beige Only
SP1010B Lid - S240 - Beige
SP1053 Sump - S240 - Beige
SP1060 Side Panel - Beige

LIDS & SUMPS D400 / D500 TWIN FAN



Beige Only

SP1532 Lid - D500 - Beige
SP1530 Sump - D4/500 - Beige
SP9612 Lid Support Brace

LIDS, SUMP & SIDE PANELS M240 MOBILE

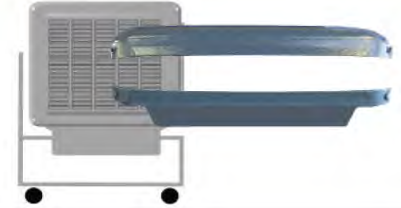

Blue Only

SP1010U Lid - M240 - Blue
2000-2019
SP1080 Sump - M240 - Blue
SP1061 Side Panel - Blue
2020 on M240WC
SP1081* Sump - M240WC
SP1062* Side Panel - M240WC
*specify colour

LIDS, SUMP & SIDE PANELS S105

Beige Only



LIDS, SUMP & SIDE PANELS

Beige Only

SP1055 Lid & Sump Set
not available individually
SP1059 Side Panel - each

LIDS & SUMPS TOP DISCHARGE

Beige Only



LIDS, SUMP & SIDE PANELS

T240 Beige Only

SP1072 Lid - Top Dis.- Beige
includes Corner Brackets
SP1052 Sump - Top Dis.- Beige

FLEXIBLE TRANSITION SKIRT S240 & T series

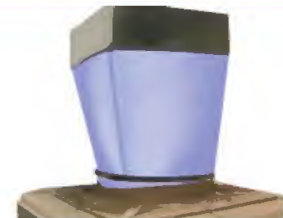

inc. with S240 & T series Units

SP6607 Flexible Connector
SP6608 Connector Clamp

Note: Colours may vary slightly to original for pre-2000 models

LOUVRES HERITAGE 2000 on & Top Discharge



Louvres sold individually
*specify colour

SP066*	D095
SP068*	D125/160
SP070*	D195
SP072*	D230
SP074*	D255

LOUVRES D400 / D500 TWIN FAN



Louvres sold individually
Beige Only

SP0530	D400 Louvres - Ends [2]
SP0532	D400 Louvres - Sides [4]
SP0534	D500 Louvres - Ends [2]
SP0535	D500 Louvres - Sides [4]

LOUVRES M240 MOBILE



Louvres sold individually
Blue Only

SP063U	M240
	Louvres - Blue x3

LOUVRES CASCADE 2000 on C125 / C160



Louvres sold individually
*specify colour

SP076*	C125/160 Front Louvre
SP078*	C125/160 Right Louvre
SP080*	C125/160 Left Louvre
SP082*	C125/160 Back Louvre

LOUVRES CASCADE 2000 on C205



Louvres sold individually
*specify colour

SP084*	C205 Front Louvre
SP086*	C205 Right Louvre
SP088*	C205 Left Louvre
SP090*	C205 Back Louvre

LOUVRES CASCADE 2000 on C240



Louvres sold individually
*specify colour

SP092*	C240	Front Louvre
SP094*	C240	Right Louvre
SP096*	C240	Left Louvre
SP098*	C240	Back Louvre

FRAME COMPONENTS - M240 M240 MOBILE



Blue Only

SP9604	Castor with Brake
SP9605	Castor without Brake
SP9609	Diffuser Grille - Blue

LOUVRES S240



Louvres sold individually
S240 Beige Only

SP063B	S240 Louvres -
--------	----------------

LOUVRES S105 Beige Only



Louvres sold individually
Beige Only

SP063B	Front Louvre - Beige
SP065B	Side Louvre - Beige

TOUCH UP PAINT SPRAY CAN

UASPB	Beige Touch-up Paint
UASPE	Black Touch-up Paint
UASPN	Green Touch-up Paint
UASPR	Red Touch-up Paint
UASPU	Blue Touch-up Paint
UASPY	Grey Touch-up Paint

PLATINUM II - Touchscreen



SP3719 Platinum II - Touchscreen

PLATINUM II - Control Module



SP3718 Platinum II - Control Box - Blue

ENERGYWISE 6 ZONE SYSTEM Wall Controller & Control Module



SP3714 Wall Controller
SP3715 Control Module

EZYZONE CONTROL CABLES



SP3707 Damper Motor Cable
SP3708 AC Power Cable
SP3717 Keypad Ext Cable

COMFORT CONTROL SYSTEM CCS - Sensors



SP3712 Zone Sensor
- inc. 6m cable
SP3713 Duct Sensor

TRANSFORMER 240v - 24v



SP3716 240v - 24v Transformer

ZONE MOTORS 24v - White



inc. Adaptor kit.
Screws onto Damper
SP6065 24v WHITE
Damper Motor
suits Ezyzone systems - 3 core cable

ZONE MOTORS 240v - Blue



Motor screws onto Damper
3 core cable
240v BLUE Damper Motor **NLA**
replaced by ...
SP6066K Motor & Bracket Set

ZONE MOTORS 24v - WHITE - EZYZONE



RJ connector on cable
Screws onto Damper
SP6068 24v WHITE
Damper Motor

ZONE MOTORS 24v - GREY - FASTFIT



suits FASTFIT dampers only
24v
SP6069 24v GREY
Damper Motor

ZONE MOTORS 240v - YELLOW - FASTFIT



suits FASTFIT dampers only
240v
SP6071 240v YELLOW
Damper Motor

VENT CLIPS



Quietflo 2005 - 2016
Pack of 4
SP9001 Vent Clips *Quietflo* 2005 - 2016
- No Longer Available
SP9002 Vent Clips - *Ezyvent* 1994-04 & 2017 on

ECOPADS FILTER PAD CATALOGUE

NO FORMALDEHYDE - NO BAD SMELL

COOLBREEZE HERITAGE

2000 ON



Set of 4 pads

SP4300/4	D095	830 x 370 x 75
SP4302/4	D125	830 x 460 x 75
SP4304/4	D160	830 x 460 x 100
SP4306/4	D195	830 x 535 x 100
SP4308/4	D230	830 x 650 x 100
SP4310/4	D255	830 x 770 x 100

COOLBREEZE CASCADE

2000 ON



Set of 4 pads

SP4312/4	C125	Front: 830 x 640 x 75 Back: 830 x 275 x 75 Sides: 830 x 640/300 x 75
SP4318/4	C160	Front: 830 x 640 x 100 Back: 830 x 275 x 100 Sides: 830 x 640/300 x 100
SP4324/4	C205	Front: 830 x 760 x 100 Back: 830 x 395 x 100 Sides: 830 x 760/420 x 100
SP4330/4	C240	Front: 830 x 870 x 100 Back: 830 x 505 x 100 Sides: 830 x 870/530 x 100

COOLBREEZE

1994 - 1997

CO / CZ / MX series

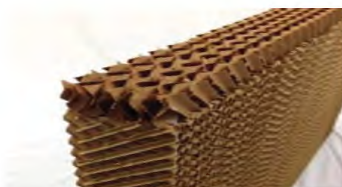

Set of 4 pads

30mm Water Distribution Strip at Top of Pads

SP4146/4	80	735 x 310 x 75
SP4148/4	105	735 x 400 x 75
SP4150/4	130	735 x 495 x 75
SP4152/4	160	840 x 495 x 75
SP4154/4	185	840 x 630 x 75
SP4156/4	210	840 x 730 x 75
SP4157/4	250	840 x 930 x 75

COOLBREEZE

1997-2000

CO / CZ / MX series



Set of 4 pads

SP4174/4	80	735 x 310 x 75
SP4176/4	105	735 x 400 x 75
SP4178/4	130	735 x 495 x 75
SP4180/4	160	840 x 495 x 75
SP4182/4	185	840 x 630 x 75
SP4184/4	210	840 x 730 x 75
SP4186/4	250	840 x 930 x 75

COOLBREEZE 1991-1992 LP series



30mm Water Distribution Strip at Top of Pads
Individual Pads - Made to Order Only

SP4110	LP110	840 x 300 x 75
SP4112	LP125	840 x 360 x 75
SP4114	LP135	840 x 430 x 75
SP4116	LP160	840 x 600 x 75
SP4118	LP185	840 x 675 x 75

COOLBREEZE 1992 LP series



30mm Water Distribution Strip at Top of Pads
Individual Pads - Made to Order Only

SP4120	LP60 +	925 x 380 x 75
SP4122	LP85 +	925 x 485 x 75
SP4124	LP95 +	925 x 530 x 75
SP4125	LP110	840 x 350 x 75
SP4126	LP120	840 x 430 x 75
SP4128	LP150	840 x 630 x 75
SP4130	LP190	840 x 695 x 75

+ = Pitched Roof model - only 2 pads per unit

COOLBREEZE 1993 FP / PR series



Individual Pads - Made to Order Only

SP4132	PR65 +	920 x 380 x 75
SP4134	PR90 +	920 x 480 x 75
SP4136	PR105+	920 x 570 x 75
SP4138	FP120	840 x 360 x 75
SP4140	FP140	840 x 430 x 75
SP4142	FP170	840 x 630 x 75
SP4144	FP200	840 x 695 x 75

+ = Pitched Roof model - only 2 pads per unit

COOLBREEZE Side Discharge S100 & S105



Pads sold individually unless described as a 'set'

1997-2002		Grooved pads	
SP4186	\$100	Front pad 840 x 930 x 75	MTO
SP4188	\$100	Side pad 275 x 930 x 75	MTO
2003 on		Grooved pads	
SP4190/3	\$105	75 Set of 3 Pads	

COOLBREEZE Side Discharge S200 / P250 / S240



Made to Order only

Pads sold individually unless described as a 'set'

SP4186	S200/P250	All sides 840 x 930 x 75	MTO
		<i>Grooved pads</i>	
SP4187/3	S240	Set of 3 Pads	
		<i>Grooved pads</i>	

COOLBREEZE M240 Mobile unit



Pads sold individually unless described as a 'set'

2001-02			
SP4189	M240	830 x 950 x 75	MTO
2003 on			
SP4187	M240	830 x 950 x 100	
SP4187/3	M240	Set of 3 pads	

COOLBREEZE Twin Fan D500



SP4548/6	D500 Ends (x2) 930 x 960 x 100
	D500 Sides (x4) 645 x 960 x 100
	D500 Set of 6 Pads

U / EX series 2002-2006



Made to Order
Pads sold individually

SP4570	Front	800 x 385 x 90
SP4573	U/EX Back	800 x 345 x 90
SP4571	125 Left	800 x 355 x 90
SP4572	Right	800 x 355 x 90
SP4574	Front	800 x 585 x 80
SP4577	U/EX Back	800 x 545 x 80
SP4575	165 Left	800 x 555-585 x 80
SP4576	Right	800 x 555-585 x 80

Pads sold individually

EZYCOOL 2000-2003



Made to Order
Pads sold individually

SP4610	L105	820 x 315 x 60	NLA
SP4611	L110/125V	820 x 315 x 75	
SP4612	L130/145V	820 x 315 x 100	
SP4613	L150/165V	820 x 430 x 75	
SP4614	L170/185V L155V	820 x 440 x 100	
SP4615	L190/205V	820 x 555 x 75	
SP4616	L210/225V L200V	820 x 565 x 100	

U / EX series 2002-2006



Made to Order
Pads sold individually

SP4578	Front	800 x 585 x 100
SP4581	U/EX Back	800 x 545 x 100
SP4579	220 Left	800 x 555-585 x 100
SP4580	Right	800 x 555-585 x 100
SP4582	Front	800 x 795 x 100
SP4585	U/EX Back	800 x 755 x 100
SP4583	260 Left	800 x 765-795 x 100
SP4584	Right	800 x 765-795 x 100

EZYCOOL 2016 on >



SET OF 4 PADS

SP4300/4	095/100	830 x 370 x 75
SP4302/4	125/140	830 x 460 x 75
SP4304/4	165/180	830 x 460 x 100
SP4306/4	195/220	830 x 535 x 100

COMFORT BREEZE 2000-2003



Made to Order

Pads sold individually

SP4610	105V	820 x 305 x 60	NLA
SP4611	110/125V	820 x 305/315 x 75	
SP4612	130/145V	820 x 315 x 100	
SP4613	150/165V	820 x 430 x 75	
SP4614	170/185V	820 x 440 x 100	
SP4615	190/205V	820 x 555 x 75	
SP4616	210/225V	820 x 565 x 100	
SP4612	L110V	820 x 315 x 100	
SP4614	L155V	820 x 440 x 100	
SP4616	L200V	820 x 565 x 100	

COMFORT BREEZE - SLOPING MODELS 2000-2003



Made to Order

Pads sold individually

SP4621		Front - 820 x 330 x 75
SP4622	110/125S	Back - 820 x 268 x 75
SP4623		Left - 820 x 305 x 75
SP4624		Right - 820 x 305 x 75
SP4625		Front - 820 x 325 x 100
SP4626	130/145S	Back - 820 x 273 x 100
SP4627		Left - 820 x 305 x 100
SP4628		Right - 820 x 305 x 100
SP4629		Front - 820 x 455 x 75
SP4630	150/165S	Back - 820 x 393 x 75
SP4631		Left - 820 x 455 x 75
SP4632		Right - 820 x 455 x 75
SP4633		Front - 820 x 450 x 100
SP4634	170/185S	Back - 820 x 398 x 100
SP4635		Left - 820 x 430 x 100
SP4636		Right - 820 x 430 x 100
SP4637		Front - 820 x 580 x 75
SP4638	190/205S	Back - 820 x 518 x 75
SP4639		Left - 820 x 555 x 75
SP4640		Right - 820 x 555 x 75
SP4641		Front - 820 x 575 x 100
SP4642	210/225S	Back - 820 x 523 x 100
SP4643		Left - 820 x 555 x 100
SP4644		Right - 820 x 555 x 100
SP4621		Front - 820 x 330 x 75
SP4622	L110S	Back - 820 x 268 x 75
SP4623		Right - 820 x 305 x 75
SP4624		Left - 820 x 305 x 75
SP4645		Front - 820 x 450 x 100

AIRGROUP AUSTRALIA - TERMS & CONDITIONS - 2021

Prices are valid from 1st October, 2021 but are subject to change without notice. Goods will be charged at the correct price on the day of invoicing. Please check to make sure that the correct goods have been received and notify AirGroup Australia immediately if they are not correct or if any items are short supplied. Inspect all items for damage, eg: dents, scratches, etc BEFORE installing the product. **IF THERE IS ANY DAMAGE DO NOT INSTALL THE ITEM** - contact AirGroup Australia immediately. AirGroup Australia WILL NOT accept for return or credit any damaged product that has been installed even if it has not been used. AirGroup Australia WILL NOT reimburse any removal or re-installation costs. A re-stocking fee may apply to goods returned for credit; delivery fees will not be credited. Custom made sheet-metal items are not returnable for credit unless manufactured incorrectly. Always provide drawings with dimensions to ensure items are made to your design. **We will only accept goods back if notified within 7 days of you receiving them.** Returned goods are subject to both inspection and a re-stocking fee. All goods remain the property of AirGroup Australia until they are paid for. The purchaser is responsible for any loss or damage to the goods whether by theft, accident or any other cause once the goods have been despatched from AirGroup Australia. Goods will not be supplied if there is any outstanding amount not paid for by the appropriate due date. AirGroup Australia will not be liable for any claim or expenses incurred by late delivery of the goods. Claims for transport loss or damage must be made to your nominated carrier. Please advise your customers of the manufacturer's warranty conditions including limitations where the unit is installed at a premises more than 25km from a service agent, or in cases where special access equipment is required for servicing the units, these costs are not covered by warranty and will be the responsibility of the customer. Images shown may depict a product feature or design without fully reflecting the product overall. Please refer to product details and specifications when making a final selection for purchase.



AIRGROUP
Australia

HEAD OFFICE & MANUFACTURING
28 Division Street
Welshpool WA 6106
08 9350 2200
order@airgroup.com.au

VICTORIA OFFICE & WAREHOUSE
5 Hawker Street
Airport West VIC 3042
03 8336 1042
ordersvic@airgroup.com.au